

EUROPEAN PATENT OFFICE
U.S. PATENT AND TRADEMARK OFFICE

CPC NOTICE OF CHANGES 665

DATE: MAY 1, 2019

PROJECT MP0428

The following classification changes will be effected by this Notice of Changes:

<u>Action</u>	<u>Subclass</u>	<u>Group(s)</u>
SCHEME:		
Titles Changed:	A61B	5/0464
		10/0045
		17/0218
	A61F	2002/7818, 2/30767, 2/30771
		2013/00229, 2013/00234, 2013/00246, 13/15
	A61H	7/00
	A61K	8/368
		31/438
	A61M	2025/0197
		2202/02
	B05D	7/225
	B24B	3/605
	B41N	SUBCLASS
	B60C	5/14
	B60L	15/2036
	B65D	5/0254
		2571/00135
	B65G	47/46
	B66C	23/821
	E03F	5/10
	F02M	21/0212
	G05B	2219/1198, 2219/2658, 2219/31452, 2219/33099, 2219/34451, 2219/34464, 2219/49016
	G05D	1/0246
	H01L	2924/19103, 2924/19104
	H04L	12/2807
		45/122
	H04Q	2213/214
	H05B	41/2858
	H05G	1/58
	H05K	1/0289
		9/0047
Notes Modified:	A61M	2025/1047
		2230/00
Guidance Headings Deleted:	F23B	2101/00 -2700/037
Guidance Headings New:	F23B	99/00 -2900/99001

CPC NOTICE OF CHANGES 665

DATE: MAY 1, 2019

PROJECT MP0428

<u>Action</u>	<u>Subclass</u>	<u>Group(s)</u>
DEFINITIONS:		
Definitions Deleted: (no frozen (F) symbol definitions should be deleted)	A61F	2/4603
	A61M	1/1081
	A61M 2025/0197	2025/0197
	B30B	9/14
	F16C	32/06
Definitions New:	F16C	32/00
Definitions Modified:	A41B	9/12
		11/006
	A44C	15/007
	A61B	1/00133
		3/113
		5/0464, 5/16, 5/4547, 5/6885
		8/0891
		10/0045, 10/0283
		17/0218, 2017/1205, 17/154
		2090/037
	A61F	2/0095, 2/013, 2/30771, 2/4405, 2/82
		13/15
	A61H	7/00
	A61J	7/00
	A61M	1/1053
		5/00
		21/00
		25/0194, 2025/0687
	B27K	1/00
	B60G	Subclass
	B60H	1/00371, 1/00385, 1/34
	B64C	13/12
	B64F	1/366
	B67B	Subclass
	C08K	5/00
	C09C	Subclass
	F16D	Subclass, 65/78
	G06F	11/22
	G08G	1/16
	H04L	12/2807
	H04W	72/00

This Notice of Changes includes the following [Check the ones included]:

1. CLASSIFICATION SCHEME CHANGES

- A. New, Modified or Deleted Group(s)
- B. New, Modified or Deleted Warning(s)
- C. New, Modified or Deleted Note(s)

CPC NOTICE OF CHANGES 665

DATE: MAY 1, 2019

PROJECT MP0428

D. New, Modified or Deleted Guidance Heading(s)

2. DEFINITIONS

A. New or Modified Definitions (Full definition template)

B. Modified or Deleted Definitions (Definitions Quick Fix)

3. REVISION CONCORDANCE LIST (RCL)

4. CHANGES TO THE CPC-TO-IPC CONCORDANCE LIST (CICL)

5. CHANGES TO THE CROSS-REFERENCE LIST (CRL)

CPC NOTICE OF CHANGES 665

DATE: MAY 1, 2019

PROJECT MP0428

1. CLASSIFICATION SCHEME CHANGES

A. New, Modified or Deleted Group(s)

SUBCLASS A61B - DIAGNOSIS; SURGERY; IDENTIFICATION (analysing biological material G01N, e.g. G01N 33/48; obtaining records using waves other than optical waves, in general G03B 42/00)

<u>Type*</u>	<u>Symbol</u>	<u>Indent Level Number of dots (e.g. 0, 1, 2)</u>	<u>Title (new or modified)</u> <u>“CPC only” text should normally be enclosed in {curly brackets}**</u>	<u>Transferred to#</u>
M	A61B 5/0464	4	Detecting tachycardy {tachycardia} or brachycardy {brachycardia}	
M	A61B 10/0045	1	{Devices for taking samples of body liquids (devices for taking blood samples A61B 5/15)}	
M	A61B 17/0218	2	{for minimally invasive surgery (A61B 17/0281, A61B 17/0469, A61B 17/12013, A61B 17/1285, A61B 17/29, A61B 17/320016 take precedence)}	

SUBCLASS A61F - FILTERS IMPLANTABLE INTO BLOOD VESSELS; PROSTHESES; DEVICES PROVIDING PATENCY TO, OR PREVENTING COLLAPSING OF, TUBULAR STRUCTURES OF THE BODY, E.G. STENTS; ORTHOPAEDIC, NURSING OR CONTRACEPTIVE DEVICES; FOMENTATION; TREATMENT OR PROTECTION OF EYES OR EARS; BANDAGES, DRESSINGS OR ABSORBENT PADS; FIRST-AID KITS (dental prosthetics A61C)

<u>Type*</u>	<u>Symbol</u>	<u>Indent Level Number of dots (e.g. 0, 1, 2)</u>	<u>Title (new or modified)</u> <u>“CPC only” text should normally be enclosed in {curly brackets}**</u>	<u>Transferred to#</u>
M	A61F 2002/7818	4	{Stockings or socks for the limb stump (cosmetic coverings A61F 2002/5001)}	
M	A61F 2/30767	3	{Special external or bone-contacting surfaces, e.g. coating for improving bone ingrowth}	
M	A61F 2/30771	4	{applied in original prostheses, e.g. holes or grooves}	

CPC NOTICE OF CHANGES 665

DATE: MAY 1, 2019

PROJECT MP0428

<u>Type*</u>	<u>Symbol</u>	<u>Indent Level Number of dots (e.g. 0, 1, 2)</u>	<u>Title (new or modified)</u> <u>“CPC only” text should normally be enclosed in {curly brackets}**</u>	<u>Transferred to#</u>
M	A61F 2013/00229	3	{with alginate}	
M	A61F 2013/00234	3	{metallic layer}	
M	A61F 2013/00246	2	{in a special way pervious to air or vapours}	
M	A61F 13/15	1	Absorbent pads, e.g. sanitary towels, swabs or tampons for external or internal application to the body (non-absorbent catamenial receptacles A61F5/44); Supporting or fastening means therefor; Tampon applicators	

SUBCLASS A61H - PHYSICAL THERAPY APPARATUS, e.g. DEVICES FOR LOCATING OR STIMULATING REFLEX POINTS IN THE BODY; ARTIFICIAL RESPIRATION; MASSAGE; BATHING DEVICES FOR SPECIAL THERAPEUTIC OR HYGIENIC PURPOSES OR SPECIFIC PARTS OF THE BODY (electrotherapy, magnetotherapy, radiation therapy, ultrasound therapy A61N)

<u>Type*</u>	<u>Symbol</u>	<u>Indent Level Number of dots (e.g. 0, 1, 2)</u>	<u>Title (new or modified)</u> <u>“CPC only” text should normally be enclosed in {curly brackets}**</u>	<u>Transferred to#</u>
M	A61H 7/00	0	Devices for suction-kneading massage; Devices for massaging the skin by rubbing or brushing not otherwise provided for (electro-medical massage devices applying electric current by contact A61N 1/18)	

CPC NOTICE OF CHANGES 665

DATE: MAY 1, 2019

PROJECT MP0428

SUBCLASS A61K - PREPARATIONS FOR MEDICAL, DENTAL, OR TOILET PURPOSES (devices or methods specially adapted for bringing pharmaceutical products into particular physical or administering forms A61J3/00; chemical aspects of, or use of materials for deodorisation of air, for disinfection or sterilisation, or for bandages, dressings, absorbent pads or surgical articles A61L; soap compositions C11D)

<u>Type*</u>	<u>Symbol</u>	<u>Indent Level Number of dots (e.g. 0, 1, 2)</u>	<u>Title (new or modified)</u> <u>“CPC only” text should normally be enclosed in {curly brackets}**</u>	<u>Transferred to[#]</u>
M	A61K 8/368	5	with carboxyl groups directly bound to carbon atoms of aromatic rings	
M	A61K 31/438	4	The ring being spiro-condensed with carbocyclic or heterocyclic ring systems	

SUBCLASS A61M - DEVICES FOR INTRODUCING MEDIA INTO, OR ONTO, THE BODY (introducing media into or onto the bodies of animals A61D 7/00; means for inserting tampons A61F 13/26; devices for administering food or medicines orally A61J; containers for collecting, storing or administering blood or medical fluids A61J 1/05); **DEVICES FOR TRANSDUCING BODY MEDIA OR FOR TAKING MEDIA FROM THE BODY** (surgery A61B; chemical aspects of surgical articles A61L); **DEVICES FOR PRODUCING OR ENDING SLEEP OR STUPOR**

<u>Type*</u>	<u>Symbol</u>	<u>Indent Level Number of dots (e.g. 0, 1, 2)</u>	<u>Title (new or modified)</u> <u>“CPC only” text should normally be enclosed in {curly brackets}**</u>	<u>Transferred to[#]</u>
M	A61M 2025/0197	3	{for creating an artificial passage within the body, e.g. in order to go around occlusions}	
M	A61M 2202/02	1	Gases	

CPC NOTICE OF CHANGES 665

DATE: MAY 1, 2019

PROJECT MP0428

SUBCLASS B05D - PROCESSES FOR APPLYING LIQUIDS OR OTHER FLUENT MATERIALS TO SURFACES, IN GENERAL (apparatus for applying liquids or other fluent materials to surfaces B05B, B05C; {coating of foodstuffs A23P 20/17, A23P 20/15, A23P 20/18})

<u>Type*</u>	<u>Symbol</u>	<u>Indent Level Number of dots (e.g. 0, 1, 2)</u>	<u>Title (new or modified)</u> <u>“CPC only” text should normally be enclosed in {curly brackets}**</u>	<u>Transferred to#</u>
M	B05D 7/225	3	{Coating inside the pipe}	

SUBCLASS B24B - MACHINES, DEVICES, OR PROCESSES FOR GRINDING OR POLISHING (grinding of gear teeth B23F, of screw-threads B23G 1/36; by electro-erosion B23H; abrasive or related blasting B24C; tools for grinding, buffing or sharpening B24D; polishing compositions C09G 1/00; abrasives C09K 3/14; electrolytic etching or polishing C25F 3/00; grinding arrangements for use on assembled railway tracks E01B 31/17); **DRESSING OR CONDITIONING OF ABRADING SURFACES; FEEDING OF GRINDING, POLISHING, OR LAPPING AGENTS**

<u>Type*</u>	<u>Symbol</u>	<u>Indent Level Number of dots (e.g. 0, 1, 2)</u>	<u>Title (new or modified)</u> <u>“CPC only” text should normally be enclosed in {curly brackets}**</u>	<u>Transferred to#</u>
M	B24B 3/605	2	{of surgical or dental instruments}	

SUBCLASS B41N - PRINTING PLATES OR FOILS (photosensitive material G03); **MATERIALS FOR SURFACES USED IN PRINTING MACHINES FOR PRINTING, INKING, DAMPING, OR THE LIKE; PREPARING SUCH SURFACES FOR USE AND CONSERVING THEM**

<u>Type*</u>	<u>Symbol</u>	<u>Indent Level Number of dots (e.g. 0, 1, 2)</u>	<u>Title (new or modified)</u> <u>“CPC only” text should normally be enclosed in {curly brackets}**</u>	<u>Transferred to#</u>
M	B41N	Subclass	PRINTING PLATES OR FOILS (photosensitive material G03); MATERIALS FOR SURFACES USED IN PRINTING MACHINES FOR PRINTING, INKING, DAMPING, OR THE LIKE; PREPARING SUCH SURFACES FOR USE AND CONSERVING THEM	

CPC NOTICE OF CHANGES 665

DATE: MAY 1, 2019

PROJECT MP0428

SUBCLASS B60C - VEHICLE TYRES (manufacture B29); TYRE INFLATION; TYRE CHANGING OR REPAIRING; REPAIRING, OR CONNECTING VALVES TO, INFLATABLE ELASTIC BODIES IN GENERAL; DEVICES OR ARRANGEMENTS RELATED TO TYRES (testing of tyres G01M17/02)

<u>Type*</u>	<u>Symbol</u>	<u>Indent Level Number of dots (e.g. 0, 1, 2)</u>	<u>Title</u> “CPC only” text should normally be enclosed in {curly brackets}**	<u>Transferred to[#]</u>
M	B60C 5/14	2	with impervious liner or coating on the inner wall of the tyre	

SUBCLASS B60L - PROPULSION OF ELECTRICALLY-PROPELLED VEHICLES (arrangements or mounting of electrical propulsion units or of plural diverse prime-movers for mutual or common propulsion in vehicles B60K1/00, B60K6/20; arrangements or mounting of electrical gearing in vehicles B60K17/12, B60K17/14; preventing wheel slip by reducing power in rail vehicles B61C15/08; dynamo-electric machines H02K; control or regulation of electric motors H02P); SUPPLYING ELECTRIC POWER FOR AUXILIARY EQUIPMENT OF ELECTRICALLY-PROPELLED VEHICLES (electric coupling devices combined with mechanical couplings of vehicles B60D1/64; electric heating for vehicles B60H1/00); ELECTRODYNAMIC BRAKE SYSTEMS FOR VEHICLES IN GENERAL (control or regulation of electric motors H02P); MAGNETIC SUSPENSION OR LEVITATION FOR VEHICLES; MONITORING OPERATING VARIABLES OF ELECTRICALLY-PROPELLED VEHICLES; ELECTRIC SAFETY DEVICES FOR ELECTRICALLY-PROPELLED VEHICLES

<u>Type*</u>	<u>Symbol</u>	<u>Indent Level Number of dots (e.g. 0, 1, 2)</u>	<u>Title</u> (new or modified) “CPC only” text should normally be enclosed in {curly brackets}**	<u>Transferred to[#]</u>
M	B60L 15/2036	2	{Electric differentials, e.g. for supporting steering vehicles}	

CPC NOTICE OF CHANGES 665

DATE: MAY 1, 2019

PROJECT MP0428

SUBCLASS B65D - CONTAINERS FOR STORAGE OR TRANSPORT OF ARTICLES OR MATERIALS, e.g. BAGS, BARRELS, BOTTLES, BOXES, CANS, CARTONS, CRATES, DRUMS, JARS, TANKS, HOPPERS, FORWARDING CONTAINERS; ACCESSORIES, CLOSURES, OR FITTINGS THEREFOR; PACKAGING ELEMENTS; PACKAGES

<u>Type*</u>	<u>Symbol</u>	<u>Indent Level Number of dots (e.g. 0, 1, 2)</u>	<u>Title (new or modified)</u> <u>“CPC only” text should normally be enclosed in {curly brackets}**</u>	<u>Transferred to[#]</u>
M	B65D 5/0254	2	{ with end closures formed by inward folding of flaps and securing them by means of a tongue integral with one of the flaps }	
M	B65D 2571/00135	3	integral with the wrapper	

SUBCLASS B65G - TRANSPORT OR STORAGE DEVICES, e.g. CONVEYORS FOR LOADING OR TIPPING, SHOP CONVEYOR SYSTEMS OR PNEUMATIC TUBE CONVEYORS (packaging B65B; handling thin or filamentary materials, e.g. paper sheets or thread, B65H; cranes B66C; portable mobile or lifting or hauling appliances, e.g. hoists, B66D; devices for lifting or lowering goods for loading or unloading purposes, e.g. fork-lift trucks, B66F9/00; emptying bottles, jars, casks, barrels or similar containers, not otherwise provided for, B67C9/00; delivering or transferring liquids B67D; filling or discharging vessels for liquefied, solidified or compressed gases F17C; pipe-line systems for fluids F17D)

<u>Type*</u>	<u>Symbol</u>	<u>Indent Level Number of dots (e.g. 0, 1, 2)</u>	<u>Title (new or modified)</u> <u>“CPC only” text should normally be enclosed in {curly brackets}**</u>	<u>Transferred to[#]</u>
M	B65G 47/46	2	and distributing, e.g. automatically, to desired points (in tube mail systems B65G 51/36)	

CPC NOTICE OF CHANGES 665

DATE: MAY 1, 2019

PROJECT MP0428

SUBCLASS B66C - CRANES; LOAD-ENGAGING ELEMENTS OR DEVICES FOR CRANES, CAPSTANS, WINCHES, OR TACKLES ({specially adapted for lifting invalids A61G 7/10;} rope, cable, or chain winding mechanisms, braking or detent devices therefor B66D; specially adapted for nuclear reactors G21)

<u>Type*</u>	<u>Symbol</u>	<u>Indent Level Number of dots (e.g. 0, 1, 2)</u>	<u>Title (new or modified)</u> <u>“CPC only” text should normally be enclosed in {curly brackets}**</u>	<u>Transferred to[#]</u>
M	B66C 23/821	3	{Bracing equipment for booms}	

SUBCLASS E03F - SEWERS; CESSPOOLS

<u>Type*</u>	<u>Symbol</u>	<u>Indent Level Number of dots (e.g. 0, 1, 2)</u>	<u>Title (new or modified)</u> <u>“CPC only” text should normally be enclosed in {curly brackets}**</u>	<u>Transferred to[#]</u>
M	E03F 5/10	1	Collecting-tanks; Equalising-tanks for regulating the run-off; Laying-up basins	

SUBCLASS F02M - SUPPLYING COMBUSTION ENGINES IN GENERAL WITH COMBUSTIBLE MIXTURES OR CONSTITUENTS THEREOF

<u>Type*</u>	<u>Symbol</u>	<u>Indent Level Number of dots (e.g. 0, 1, 2)</u>	<u>Title (new or modified)</u> <u>“CPC only” text should normally be enclosed in {curly brackets}**</u>	<u>Transferred to[#]</u>
M	F02M 21/0212	4	{comprising at least 3 C-Atoms, e.g. liquefied petroleum gas [LPG], propane or butane}	

CPC NOTICE OF CHANGES 665

DATE: MAY 1, 2019

PROJECT MP0428

SUBCLASS G05B - CONTROL OR REGULATING SYSTEMS IN GENERAL; FUNCTIONAL ELEMENTS OF SUCH SYSTEMS; MONITORING OR TESTING ARRANGEMENTS FOR SUCH SYSTEMS OR ELEMENTS (fluid-pressure actuators or systems acting by means of fluids in general F15B; valves per se F16K; characterised by mechanical features only G05G; sensitive elements, see the appropriate subclass, e.g. G12B, subclass of G01, H01; correcting units, see the appropriate subclass, e.g. H02K)

<u>Type*</u>	<u>Symbol</u>	<u>Indent Level Number of dots (e.g. 0, 1, 2)</u>	<u>Title (new or modified)</u> <u>“CPC only” text should normally be enclosed in {curly brackets}**</u>	<u>Transferred to#</u>
M	G05B 2219/1198	3	Activate output only if power of the output signal is sufficient	
M	G05B 2219/2658	3	Heat pump	
M	G05B 2219/31452	3	Send a warning message that an event has to be monitored before the event occurs	
M	G05B 2219/33099	3	Computer numerical control [CNC]; Software control [SWC]	
M	G05B 2219/34451	3	False alarm states evaluation, threshold to verify correctness alarm	
M	G05B 2219/34464	3	Adaptive threshold, level for alarm, eliminate false alarm	
M	G05B 2219/49016	3	Desktop manufacturing [DTM]; Solid freeform machining [SFM]; Solid freeform fabrication [SFF]	

SUBCLASS G05D - SYSTEMS FOR CONTROLLING OR REGULATING NON-ELECTRIC VARIABLES (for continuous casting of metals B22D11/16; valves per se F16K; sensing non-electric variables, see the relevant subclasses of G01; for regulating electric or magnetic variables G05F)

<u>Type*</u>	<u>Symbol</u>	<u>Indent Level Number of dots (e.g. 0, 1, 2)</u>	<u>Title (new or modified)</u> <u>“CPC only” text should normally be enclosed in {curly brackets}**</u>	<u>Transferred to#</u>
M	G05D 1/0246	4	{using a video camera in combination with image processing means}	

CPC NOTICE OF CHANGES 665

DATE: MAY 1, 2019

PROJECT MP0428

SUBCLASS H01L - SEMICONDUCTOR DEVICES; ELECTRIC SOLID STATE DEVICES NOT OTHERWISE PROVIDED FOR (use of semiconductor devices for measuring G01; resistors in general H01C; magnets, inductors, transformers H01F; capacitors in general H01G; electrolytic devices H01G9/00; batteries, accumulators H01M; waveguides, resonators, or lines of the waveguide type H01P; line connectors, current collectors H01R; stimulated-emission devices H01S; electromechanical resonators H03H; loudspeakers, microphones, gramophone pick-ups or like acoustic electromechanical transducers H04R; electric light sources in general H05B; printed circuits, hybrid circuits, casings or constructional details of electrical apparatus, manufacture of assemblages of electrical components H05K; use of semiconductor devices in circuits having a particular application, see the subclass for the application)

<u>Type*</u>	<u>Symbol</u>	<u>Indent Level Number of dots (e.g. 0, 1, 2)</u>	<u>Title (new or modified)</u> <u>“CPC only” text should normally be enclosed in {curly brackets}**</u>	<u>Transferred to[#]</u>
M	H01L 2924/19103	5	interposed between the semiconductor or solid-state device and the die mounting substrate, i.e. chip-on-passive	
M	H01L 2924/19104	5	on the semiconductor or solid-state device, i.e. passive-on-chip	

SUBCLASS H04L - TRANSMISSION OF DIGITAL INFORMATION, e.g. TELEGRAPHIC COMMUNICATION (typewriters B41J; order telegraphs, fire or police telegraphs G08B; visual telegraphy G08B, G08C; teleautographic systems G08C; ciphering or deciphering apparatus per se G09C; coding, decoding or code conversion, in general H03M; arrangements common to telegraphic and telephonic communication H04M; selecting H04Q)

<u>Type*</u>	<u>Symbol</u>	<u>Indent Level Number of dots (e.g. 0, 1, 2)</u>	<u>Title (new or modified)</u> <u>“CPC only” text should normally be enclosed in {curly brackets}**</u>	<u>Transferred to[#]</u>
M	H04L 12/2807	3	{Exchanging configuration information on appliance services in a home automation network (address allocation H04L 29/12207; arrangements for maintenance or administration involving network analysis for automatically determining the actual topology of a network H04L 41/12; hardware or software tools for network management using graphical user interfaces H04L 41/22)}	
M	H04L 45/122	2	{Minimizing distance, e.g. number of hops}	

CPC NOTICE OF CHANGES 665

DATE: MAY 1, 2019

PROJECT MP0428

SUBCLASS H04Q - SELECTING (switches, relays, selectors H01H; electronic switches H03K 17/00)

<u>Type*</u>	<u>Symbol</u>	<u>Indent Level Number of dots (e.g. 0, 1, 2)</u>	<u>Title (new or modified)</u> <u>“CPC only” text should normally be enclosed in {curly brackets}**</u>	<u>Transferred to[#]</u>
M	H04Q 2213/214	1	Phase shifted impulses; Clock signals; Timing	

SUBCLASS H05B - ELECTRIC HEATING; ELECTRIC LIGHTING NOT OTHERWISE PROVIDED FOR (apparatus for special application, see the relevant places, e.g. A47J, C21, C22, C23, F21, F24, F27)

<u>Type*</u>	<u>Symbol</u>	<u>Indent Level Number of dots (e.g. 0, 1, 2)</u>	<u>Title (new or modified)</u> <u>“CPC only” text should normally be enclosed in {curly brackets}**</u>	<u>Transferred to[#]</u>
M	H05B 41/2858	6	{ for protecting the lamp against abnormal operating conditions }	

SUBCLASS H05G - X-RAY TECHNIQUE (apparatus for radiation diagnosis A61B 6/00; X-ray therapy A61N; testing by X-rays G01N; apparatus for X-ray photography G03B; filters, conversion screens, microscopes G21K; X-ray tubes H01J 35/00; TV systems having X-ray input H04N 5/321)

<u>Type*</u>	<u>Symbol</u>	<u>Indent Level Number of dots (e.g. 0, 1, 2)</u>	<u>Title (new or modified)</u> <u>“CPC only” text should normally be enclosed in {curly brackets}**</u>	<u>Transferred to[#]</u>
M	H05G 1/58	2	Switching arrangements for changing-over from one mode of operation to another, e.g. from radioscropy to radiography, from radioscropy to irradiation {or from one tube voltage to another }	

CPC NOTICE OF CHANGES 665

DATE: MAY 1, 2019

PROJECT MP0428

SUBCLASS H05K - PRINTED CIRCUITS; CASINGS OR CONSTRUCTIONAL DETAILS OF ELECTRIC APPARATUS; MANUFACTURE OF ASSEMBLAGES OF ELECTRICAL COMPONENTS

<u>Type*</u>	<u>Symbol</u>	<u>Indent Level Number of dots (e.g. 0, 1, 2)</u>	<u>Title (new or modified) "CPC only" text should normally be enclosed in {curly brackets}**</u>	<u>Transferred to[#]</u>
M	H05K 1/0289	4	{having a matrix lay-out, i.e. having selectively interconnectable sets of X-conductors and Y-conductors in different planes}	
M	H05K 9/0047	2	{being rigid plastic containers having conductive particles, fibres or mesh embedded therein}	

*N = new entries where reclassification into entries is involved; C = entries with modified file scope where reclassification of documents from the entries is involved; Q = new entries which are firstly populated with documents via administrative transfers from deleted (D) entries. Afterwards, the transferred documents into the Q entry will either stay or be moved to more appropriate entries, as determined by intellectual reclassification; T= existing entries with enlarged file scope, which receive documents from C or D entries, e.g. when a limiting reference is removed from the entry title; M = entries with no change to the file scope (no reclassification); D = deleted entries; F = frozen entries will be deleted once reclassification of documents from the entries is completed; U = entries that are unchanged.

NOTES:

- **No {curly brackets} are used for titles in CPC only subclasses, e.g. C12Y, A23Y; 2000 series symbol titles of groups found at the end of schemes (orthogonal codes); or the Y section titles. The {curly brackets} are used for 2000 series symbol titles found interspersed throughout the main trunk schemes (breakdown codes).
- U groups: it is obligatory to display the required "anchor" symbol (U group), i.e. the entry immediately preceding a new group or an array of new groups to be created (in case new groups are not clearly subgroups of C-type groups). Always include the symbol, indent level and title of the U group in the table above.
- All entry types should be included in the scheme changes table above for better understanding of the overall scheme change picture. Symbol, indent level, and title are required for all types.
- "Transferred to" column must be completed for all C, D, F, and Q type entries. F groups will be deleted once reclassification is completed.
- When multiple symbols are included in the "Transferred to" column, avoid using ranges of symbols in order to be as precise as possible.
- For administrative transfer of documents, the following text should be used: "< administrative transfer to XX>", "<administrative transfer to XX and YY simultaneously>", or "<administrative transfer to XX, YY, ...and ZZ simultaneously>" when administrative transfer of the same documents is to more than one place.
- Administrative transfer to main trunk groups is assumed to be the source allocation type, unless otherwise indicated.
- Administrative transfer to 2000/Y series groups is assumed to be "additional information".
- If needed, instructions for allocation type should be indicated within the angle brackets using the abbreviations "ADD" or "INV": <administrative transfer to XX ADD> , <administrative transfer to XX INV>, or < administrative transfer to XX ADD, YY INV, ... and ZZ ADD simultaneously>.
- In certain situations, the "D" entries of 2000-series or Y-series groups may not require a destination ("Transferred to") symbol, however it is required to specify "<no transfer>" in the "Transferred to" column for such cases.
- For finalisation projects, the deleted "F" symbols should have <no transfer> in the "Transferred to" column.
- For more details about the types of scheme change, see CPC Guide.

CPC NOTICE OF CHANGES 665

DATE: MAY 1, 2019

PROJECT MP0428

B. New, Modified or Deleted Note(s)

SUBCLASS A61M - DEVICES FOR INTRODUCING MEDIA INTO, OR ONTO, THE BODY (introducing media into or onto the bodies of animals A61D 7/00; means for inserting tampons A61F 13/26; devices for administering food or medicines orally A61J; containers for collecting, storing or administering blood or medical fluids A61J 1/05); DEVICES FOR TRANSDUCING BODY MEDIA OR FOR TAKING MEDIA FROM THE BODY (surgery A61B; chemical aspects of surgical articles A61L); DEVICES FOR PRODUCING OR ENDING SLEEP OR STUPOR

<u>Type*</u>	<u>Location</u>	<u>Old Note</u>	<u>New/Modified Note</u>
M	A61M 2025/1047	This group covers other centering means and is not limited to balloons	This group also covers balloon catheters with centering means other than centering means using balloons
M	A61M 2230/00	+A following the symbol means that the parameter is used for controlling an apparatus The classification symbol A61M 2230/005 is not listed first when assigned to patent documents. It is used only when associated to other subgroups of A61M 2230/00. Example: A61M 2230/06 + A61M 2230/005	{In this group, symbol A61M 2230/005 is only used as subsequent symbol in C-Sets and should not be allocated as single symbols. }

*N = new note, M = modified note, D = deleted note

NOTE: The "Location" column only requires the symbol PRIOR to the location of the note. No further directions such as "before" or "after" are required.

CPC NOTICE OF CHANGES 665

DATE: MAY 1, 2019

PROJECT MP0428

C. New, Modified or Deleted Guidance Heading(s)

SUBCLASS F23B - METHODS OR APPARATUS FOR COMBUSTION USING ONLY SOLID FUEL (for combustion of fuels that are solid at room temperatures, but burned in melted form, e.g. candle wax, C11C 5/00, F23C, F23D; using solid fuel suspended in air F23C, F23D 1/00; using solid fuel suspended in liquids F23C, F23D 11/00; using solid fuel and fluent fuel simultaneously or alternately F23C, F23D 17/00; burning of low grade fuel F23G; grates F23H; feeding solid fuel to combustion apparatus F23K; combustion chambers, not otherwise provided for F23M; domestic apparatus F24; central heating boilers F24D; package boilers F24H)

<u>Type*</u>	<u>Location</u>	<u>Old Guidance Heading</u>	<u>New/Modified Guidance Heading</u>
N	F23B 2101/00 – F23B 2900/00		Indexing scheme related to adaptation of combustion apparatus to boilers
D	F23B 2103/00 - F23B 2700/00	Indexing scheme related to adaptation of combustion apparatus to boilers	

*N = new guidance heading, M =modified guidance heading, D = deleted guidance heading

NOTES:

- The “Location” column requires the symbol AFTER the guidance heading location. No further directions such as “before” or “after” are required.
- In cases where there may be confusion as to whether a new group falls within the scope of a guidance heading, indicate the guidance heading and whether the group does or does not go with the guidance heading. This can be included in the “Location” column. For example, the guidance heading “Compounds containing carbon together with sulfur, selenium or tellurium with or without hydrogen, halogens, oxygen or nitrogen” encompasses groups C07C 301/00-395/00 only. If a new group C07C 398/00 is proposed and is included in the guidance heading scope, indicate this in the “Location” column as follows: 398/00 to be included under the guidance heading: “Compounds containing carbon together with sulfur, selenium or tellurium with or without hydrogen, halogens, oxygen or nitrogen.”

2. A. DEFINITIONS (new)

Insert the following new Definition:

F16C 32/00

Definition statement

This place covers:

Details for all types of bearings, i.e. they are not limited to rotary sliding contact or rolling element bearings but, as far as applicable, they also cover the other bearing types (e.g. linear, magnetic, hydrostatic etc.).

2. A. DEFINITIONS (modified)

A61F 2/4405

Definition statement

Replace the existing image with the following modified image:

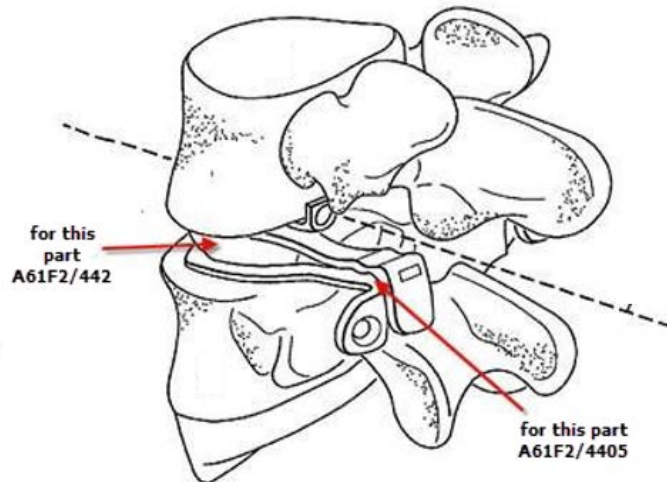

B64C 13/12

Definition statement

Delete the following image from the Definition statement:

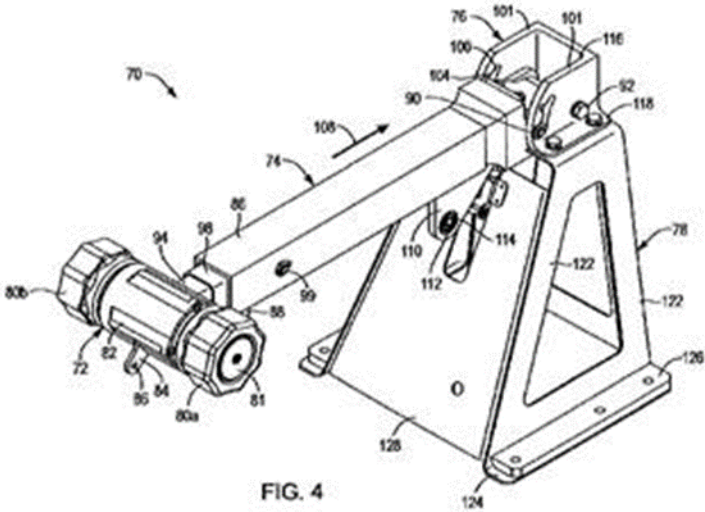

CPC NOTICE OF CHANGES 665

DATE: MAY 1, 2019

PROJECT MP0428

2. B. DEFINITIONS QUICK FIX

<u>Symbol</u>	<u>Location of change</u> (e.g., section title)	<u>Existing reference symbol or text</u>	<u>Action; New symbol; New text</u>
A41B 9/12	Limiting references	Additives (for odour) of absorbent pads A61F 13/15H8	Replace the existing symbol A61F 13/15H8 with the new symbol A61F 2013/8408 within the Limiting references table so that the row reads as follows: Additives (for odour) of absorbent pads A61F 2013/8408
A41B 11/006	Limiting references	Hosiery with shinguards A63B 71/21L	Replace the existing symbol A63B 71/21L with the new symbol A63B 71/1225 within the Limiting references table so that the row reads as follows: Hosiery with shinguards A63B 71/1225
A44C 15/007	Limiting references	Dental brackets A61C 7/04	Replace the existing symbol A61C 7/04 with the new symbol A61C 7/14 within the Limiting references table so that the row reads as follows: Dental brackets A61C 7/14
A61B 1/00133	Informative references	Operating/actuating an endoscopic tool A61B 2017/00398	Replace the existing symbol A61B 2017/00398 with the new symbol A61B 2017/00367 within the Informative references table so that the row reads as follows: Operating/actuating an endoscopic tool A61B 2017/00367

CPC NOTICE OF CHANGES 665

DATE: MAY 1, 2019

PROJECT MP0428

<u>Symbol</u>	<u>Location of change</u> (e.g., section title)	<u>Existing reference symbol or text</u>	<u>Action; New symbol; New text</u>
A61B 3/113	Informative references	Tracking eye movements during eye surgery A61F 2009/008	Replace the existing symbol A61F 2009/008 with the new symbol A61F 2009/00846 within the Informative references table so that the row reads as follows: Tracking eye movements during eye surgery A61F 2009/00846
A61B 5/0464	Limiting references	Devices provided with high/low alarm devices A61B 5/02455	Delete the entire Limiting references section.
A61B5/0464	Informative references		Insert a new Informative references section with the following table row: <i>Informative references</i> <i>Attention is drawn to the following places, which may be of interest for search:</i> Devices provided with high/low alarm devices A61B 5/02455
A61B 5/16	Special rules of classification	Classification is made in A61B 5/16 in combination with a physiological measurement, e.g. A61B 5/16 and A61B 5/0531, when appropriate.	Replace the existing Special rules of classification text with the following new text: Classification is made in A61B 5/16 and in the particular physiological measurement, e.g. A61B 5/16 and A61B 5/0531, when appropriate.

CPC NOTICE OF CHANGES 665

DATE: MAY 1, 2019

PROJECT MP0428

<u>Symbol</u>	<u>Location of change</u> (e.g., section title)	<u>Existing reference symbol or text</u>	<u>Action; New symbol; New text</u>
A61B 5/4547	Limiting references	Measuring using light, adapted to oral or dental tissue A61B5/00P8	<u>Replace</u> the existing symbol A61B 5/00P8 with the new symbol A61B 5/0088 within the Limiting references table so that the row reads as follows: Measuring using light, adapted to oral or dental tissue A61B 5/0088
A61B 5/6885	Limiting references	Detect tissue strain, i.e., tissue deformation under compression	<u>Delete</u> the following incomplete entry from the Limiting reference table: Detect tissue strain, i.e., tissue deformation under compression
A61B 8/0891	Definition statement	Mainly related to the structural diagnosis of blood vessels (since blood flow assessment is dealt with in A61B 6/06).	<u>Replace</u> the existing symbol A61B 6/06 with A61B 8/06 so that the Definition statement reads as follows: Mainly related to the structural diagnosis of blood vessels (since blood flow assessment is dealt with in A61B 8/06).
A61B 10/0045	Limiting references	Devices for taking blood samples A61B 5/1405	<u>Replace</u> the existing symbol A61B 5/1405 with the new symbol A61B 5/15 within the Limiting references table so that the row reads as follows: Devices for taking blood samples A61B 5/15

CPC NOTICE OF CHANGES 665

DATE: MAY 1, 2019

PROJECT MP0428

<u>Symbol</u>	<u>Location of change</u> (e.g., section title)	<u>Existing reference symbol or text</u>	<u>Action; New symbol; New text</u>
A61B 10/0283	Limiting references		<p><u>Insert</u> a new Limiting references section with the following <u>two</u> table rows:</p> <p><i>Limiting references</i></p> <p><i>This place does not cover:</i></p> <p>Instruments for taking bone, bone marrow or cartilage samples A61B 10/025</p> <p>Instruments with means for severing sample A61B 10/0266</p>
A61B 10/0283	Special rules of classification		<p><u>Delete</u> the entire Special rules of classification section.</p>
A61B 17/0218	Limiting references		<p><u>Delete</u> following table row from the Limiting references section:</p> <p>For minimally invasive surgery in general A61B 17/00234</p>
A61B 17/0218	Informative references		<p><u>Insert</u> a new Informative references section with the following table row:</p> <p><i>Informative references</i></p> <p><i>Attention is drawn to the following places, which may be of interest for search:</i></p> <p>For minimally invasive surgery in general A61B 17/00234</p>

CPC NOTICE OF CHANGES 665

DATE: MAY 1, 2019

PROJECT MP0428

<u>Symbol</u>	<u>Location of change</u> (e.g., section title)	<u>Existing reference symbol or text</u>	<u>Action; New symbol; New text</u>
A61B 2017/1205	Limiting references	Introducer for stents A61F 2/84	Replace the existing symbol A61F 2/84 with the new symbol A61F 2/95 within the Limiting references table so that the row reads as follows: Introducer for stents A61F 2/95
A61B 17/154	Limiting references	Cutting tibia only A61B 17/158	Replace the existing Limiting references table row text “Cutting tibia only” with the new text “Cutting patella only” so that the row reads as follows: Cutting patella only A61B 17/158
A61B 2090/037	Informative references	For prostheses A61F 2/00W8	Replace the existing symbol A61F 2/00W8 with the new symbol A61F 2250/0071 within the Informative references table so that the row reads as follows: For prostheses A61F 2250/0071
A61F 2/0095	Special rules of classification	Implants receive their particular classification symbol in combination with the class A61F 2/0095 (Example: a package for a soft heart valve prosthesis will be classified in A61F 2/0095 and A61F 2/2412).	Replace the word “class” with the word “subgroup” in the Special rules of classification section so that the text reads as follows: Implants receive their particular classification symbol in combination with the subgroup A61F 2/0095 (Example: a package for a soft heart valve prosthesis will be classified in A61F 2/0095 and A61F 2/2412).

CPC NOTICE OF CHANGES 665

DATE: MAY 1, 2019

PROJECT MP0428

<u>Symbol</u>	<u>Location of change</u> (e.g., section title)	<u>Existing reference symbol or text</u>	<u>Action; New symbol; New text</u>
A61F 2/013	Special rules of classification	Stent or stent-graft delivery devices: A61F2/84	Replace the existing symbol A61F2/84 with the new symbol A61F 2/95 within the Special rules of classification section so that the relevant portion of text reads as follows: Stent or stent-graft delivery devices: A61F 2/95
A61F 2/30771	Informative references	Etching the surface A61F 2/30767	Replace the existing text within the Informative references table row so that the row reads as follows: Etched surface A61F 2/30767
A61F 2/30771	Informative references		Insert the following new table row into the Informative references section: Etched and electrolytic etching A61F 2002/30925 , A61F 2002/30927
A61F 2/4603	Definition		Delete the entire Definition.
A61F 13/15	Limiting references		Replace the entire existing text within the Limiting references section with a table with the following reference: non-absorbent catamenial receptacles A61F 5/44

CPC NOTICE OF CHANGES 665

DATE: MAY 1, 2019

PROJECT MP0428

<u>Symbol</u>	<u>Location of change</u> (e.g., section title)	<u>Existing reference symbol or text</u>	<u>Action; New symbol; New text</u>
A61F 13/15	Application-oriented references		<p><u>Insert</u> a new Application-oriented references section as follows:</p> <p><i>Application-oriented references</i></p> <p><i>Examples of places where the subject matter of this class is covered when specially adapted, used for a particular purpose, or incorporated in a larger system:</i></p> <p>Articles for absorbing wound excretions A61F 13/00 - A61F 13/14</p>
A61F 13/15	Informative references		<p><u>Insert</u> a new Informative references section with the <u>four</u> following table rows:</p> <p><i>Informative references</i></p> <p><i>Attention is drawn to the following places, which may be of interest for search:</i></p> <p>Wet wipes A61K 8/0208</p> <p>Underwear A41B 9/00</p> <p>Pessaries A61F 6/08</p> <p>Absorption of sweat A42C 5/00, A43B 17/00, A41D 20/00</p>
A61H 7/00	Limiting references		<p><u>Insert</u> a new Limiting references section as follows:</p> <p><i>Limiting references</i></p> <p><i>This place does not cover:</i></p> <p>Electro-medical massage devices applying electric current by contact A61N 1/18</p>

CPC NOTICE OF CHANGES 665

DATE: MAY 1, 2019

PROJECT MP0428

<u>Symbol</u>	<u>Location of change</u> (e.g., section title)	<u>Existing reference symbol or text</u>	<u>Action; New symbol; New text</u>
A61H 7/00	Informative references		<u>Insert</u> the following new table row into the Informative references section: Massage by means of rollers and balls A61H 15/00
A61H 7/00	Special rules of classification	Rollers and balls therefore are classified in A61B 15/00.	<u>Delete</u> the following portion of text from the Special rules of classification section: Rollers and balls therefore are classified in A61B 15/00.
A61J 7/00	Special rules of classification	Means for oral administration should always be classified in A61J 7/0015 - A61J 7/0061 or A61J 7/0015 - A61J 7/0061.	<u>Replace</u> the existing text within the Special rules of classification with the following new text: Means for oral administration should always be classified in A61J 7/0015 - A61J 7/0061.
A61M 1/1053	Limiting references		<u>Delete</u> the entire Limiting references section.
A61M 1/1081	Limiting references		<u>Delete</u> the entire Definition.
A61M 5/00	Special rules of classification	In A61B 8/0891, the blood vessels is analysed for diagnosis purpose only. All couplings and connectors are classified in A61M 39/00.	<u>Replace</u> the <u>third</u> paragraph of the Special rules of classification section with the following revised text: In A61B 8/0891, the blood vessel is analysed for diagnosis purpose using ultrasonic, sonic, or infrasonic waves. All couplings and connectors are classified in A61M 39/00.
A61M 21/00	Limiting references		<u>Delete</u> the entire Limiting references section.

CPC NOTICE OF CHANGES 665

DATE: MAY 1, 2019

PROJECT MP0428

<u>Symbol</u>	<u>Location of change</u> (e.g., section title)	<u>Existing reference symbol or text</u>	<u>Action; New symbol; New text</u>
A61M 21/00	Informative references		<u>Insert</u> the following new table row into the Informative references section: Alarm clocks G04B 23/00 , G04C 21/00
A61M 25/0194	Limiting references	For creating artificial passage within the body A61M 2025/0197	<u>Delete</u> the entire References/Limiting references section.
A61M 2025/0197	Limiting references	For fixation outside the body A61M 25/0194	<u>Delete</u> the entire Definition.
A61M 2025/0687	Special rules of classification	Documents should get a classification in A61M 29/00 as well.	<u>Replace</u> the existing text in the Special rules of classification section with the following revised text: Documents which disclose special designs of dilators should be classified in A61M 29/00 as well.
B27K 1/00	Relationships with other classification places	Steam drying of wood is covered by B26F.	<u>Replace</u> the existing text with the following new text: Steam drying wood is covered by F26B.
B30B 9/14	Definition		<u>Delete</u> the entire Definition.
B60G	Special rules of classification	For the whole B60G range, consider the indexing range B60G 1/00 – B60G 99/008	<u>Replace</u> the symbol range B60G 1/00 – B60G 99/008 in the Special rules of classification section with the symbol range B60G 2200/00 – B60G 2800/00 so that the text reads as follows: For the whole B60G range, consider the indexing range B60G 2200/00 – B60G 2800/00
B60H 1/00371	Informative references	Buses FTerm: 3L211/AA05	<u>Delete</u> the entire Informative references section.

CPC NOTICE OF CHANGES 665

DATE: MAY 1, 2019

PROJECT MP0428

<u>Symbol</u>	<u>Location of change</u> (e.g., section title)	<u>Existing reference symbol or text</u>	<u>Action; New symbol; New text</u>
B60H 1/00385	Informative references	Hybrid vehicles FTerms: 3L211/AA10 Electric vehicles FTerms: 3L211/AA11	Delete the following two table rows from the Informative references section: Hybrid vehicles FTerms: 3L211/AA10 Electric vehicles FTerms: 3L211/AA11
B60H 1/34	Informative references	Outlets for directing or distributing air into rooms or spaces for domestic air-conditioning F24F 13/06, F24F 13/08, F24F 13/10, F24F 13/14. FI: B60H1/34&611, 631, 651, 671 FTerms: 3L081/...	Delete the following text from the Informative references table: FI: B60H1/34&611, 631, 651, 671 FTerms: 3L081/...
B64F 1/366	Special rules of classification		Delete the entire Special rules of classification section.
B67B	Definition statement		Insert the following text as a distinct paragraph at the end of the existing Definition statement: Apparatuses for applying closures and/or covers (of closures) to gas bottles.
B67B	Limiting references		Delete the following table row from the Limiting references section: Apparatuses for applying closures and/or covers (of closures) to gas bottles are historically B67B
C08K 5/00	Limiting references		Delete the entire Limiting references section.

CPC NOTICE OF CHANGES 665

DATE: MAY 1, 2019

PROJECT MP0428

<u>Symbol</u>	<u>Location of change</u> (e.g., section title)	<u>Existing reference symbol or text</u>	<u>Action; New symbol; New text</u>
C09C	Special rules of classification	When classifying in this subclass, symbols of C01P and are used to identify structural or physical aspects of solid inorganic compounds.	<u>Replace</u> the <u>fourth</u> paragraph of text within the Special rules of classification section with the following revised text: When classifying in this subclass, symbols of C01P are used to identify structural or physical aspects of solid inorganic compounds.
F16C 32/06	Definition		<u>Delete</u> the entire Definition.
F16D	Special rules of classification	The IPC-guide refers to "invention information". This definition is not followed, since "the addition to the prior art" of most documents is not always clear. In subclass F16D the criteria for classification derive from the main rule that all relevant technical information of a document is classified to allow efficient retrieval. Therefore multi-aspect classification is used and most documents should preferably have two or more classification symbols. One symbol to describe the general configuration or overall construction and one or more further symbols to identify additional features should be assigned.	<u>Replace</u> the <u>fifth</u> paragraph of text in the Special rules of classification section with the following revised text: The IPC-guide refers to "invention information". This definition is not followed, since "the addition to the prior art" of most documents is not always clear. In subclass F16D the criteria for classification derive from the main rule that all relevant technical information of a document is classified to allow efficient retrieval. Therefore multi-aspect classification is used and most documents should preferably have two or more classification symbols. One symbol to describe the general configuration or overall construction and one or more further symbols to identify additional features should be assigned.
F16D 65/78	Special rules of classification	Additional classification is given in groups F16D78/00	<u>Delete</u> the entire Special rules of classification section.

CPC NOTICE OF CHANGES 665

DATE: MAY 1, 2019

PROJECT MP0428

<u>Symbol</u>	<u>Location of change</u> (e.g., section title)	<u>Existing reference symbol or text</u>	<u>Action; New symbol; New text</u>
G06F 11/22	Glossary of terms	Computer hardware - a digital circuit which has programmable processing logic incorporated.	<p>Replace “incorporated” with “incorporated” in the Glossary of terms table so that the row reads as follows:</p> <p>Computer hardware - a digital circuit which has programmable processing logic incorporated.</p>
G08G 1/16	Special rules of classification	To combine with Indexing Codes for stand-alone systems to monitor the surroundings of a vehicle.	<p>Delete the entire Special rules of classification section.</p>
H04L 12/2807	Limiting references		<p>Delete the following <u>two</u> table rows from the Limiting references section:</p> <p>Network management of home networks, for instance by initialisation of the network, configuration and self-configuration of the network H04L 41/00</p> <p>Configuration of devices by assignment of identifiers and addresses H04L 61/00</p>

CPC NOTICE OF CHANGES 665

DATE: MAY 1, 2019

PROJECT MP0428

<u>Symbol</u>	<u>Location of change</u> (e.g., section title)	<u>Existing reference symbol or text</u>	<u>Action; New symbol; New text</u>
H04W 72/00	Definition statement	<p>Processing originating user or terminal resource requests for the purpose of allocating one or a plurality of local wireless resources to the user or terminal. Allocating one or a plurality of local wireless resources in response to a terminating user or terminal communication request.</p> <p>Controlling wireless resource requests (grant or denial) and wireless resource allocation among contending users or terminals.</p> <p>Selection of wireless resources by user or terminal.</p> <p>Allocation one or a plurality of local wireless resources based on certain criteria or to fulfil certain requirements. In this group, a relaying equipment is considered as local access point for the requester. This group implicitly includes deallocation of resources.</p>	<p>Insert a space in the <u>second</u> paragraph after “requests” and change “in” to “In” in the <u>fourth</u> paragraph so that the text reads as follows:</p> <p>Processing originating user or terminal resource requests for the purpose of allocating one or a plurality of local wireless resources to the user or terminal. Allocating one or a plurality of local wireless resources in response to a terminating user or terminal communication request.</p> <p>Controlling wireless resource requests (grant or denial) and wireless resource allocation among contending users or terminals.</p> <p>Selection of wireless resources by user or terminal.</p> <p>Allocation one or a plurality of local wireless resources based on certain criteria or to fulfil certain requirements. In this group, a relaying equipment is considered as local access point for the requester. This group implicitly includes deallocation of resources.</p>

NOTES:

- The table above is used for corrections or modifications to existing definitions, e.g. delete an entire definition or part thereof; propose new wording or modify wording of a section, change the symbol the definition is associated with, change or delete a reference symbol, etc.
- Do not delete (F) symbol definitions.