

EUROPEAN PATENT OFFICE
U.S. PATENT AND TRADEMARK OFFICE

CPC NOTICE OF CHANGES 310

DATE: NOVEMBER 1, 2016

PROJECT RP0028

The following classification changes will be effected by this Notice of Changes:

<u>Action</u>	<u>Subclass</u>	<u>Group(s)</u>
Symbol deleted:	B62K	3/007
Symbol newly created:	B62K	11/007
Deleted definition:	B62K	3/007
New definition:	B62K	11/007

The following subclasses/groups are also impacted by this Notice of Changes (indicate subclasses/groups outside of the project scope, such as those listed in the CRL):

B62H

This Notice of Changes includes the following [Check the ones included]:

1. CLASSIFICATION SCHEME CHANGES
 - A. New, Modified or Deleted Group(s)
 - B. New, Modified or Deleted Warning Notice(s)
 - C. New, Modified or Deleted Note(s)
 - D. New, Modified or Deleted Guidance Heading(s)
2. DEFINITIONS (New or Modified)
 - A. DEFINITIONS (Full definition template)
 - B. DEFINITIONS (Definitions Quick Fix)
3. REVISION CONCORDANCE LIST (RCL)
4. CHANGES TO THE CPC-TO-IPC CONCORDANCE LIST (CICL)
5. CROSS-REFERENCE LIST (CRL)

CPC NOTICE OF CHANGES 310

DATE: NOVEMBER 1, 2016

PROJECT RP0028

1. CLASSIFICATION SCHEME CHANGES

A. New, Modified or Deleted Group(s)

SUBCLASS B62K - CYCLES; CYCLE FRAMES; CYCLE STEERING DEVICES; RIDER-OPERATED TERMINAL CONTROLS SPECIALLY ADAPTED FOR CYCLES; CYCLE AXLE SUSPENSIONS; CYCLE SIDECARS, FORECARS, OR THE LIKE

<u>Type*</u>	<u>Symbol</u>	<u>Indent Level Number of dots (e.g. 0, 1, 2)</u>	<u>Title (new or modified) "CPC only" text should normally be enclosed in {curly brackets}**</u>	<u>Transferred to[#]</u>
U	B62K3/005	1	{Recumbent-type bicycles}	
D	B62K3/007	1		<administrative transfer to B62K11/007>
U	B62K11/00	0	Motorcycles, engine-assisted cycles or motor scooters with one or two wheels (fairings or streamlining parts not forming part of the frame B62J; transmission of drive from engines to wheels B62M)	
N	B62K11/007	1	{Automatic balancing machines with single main ground engaging wheel or coaxial wheels supporting a rider}	

*N = new entries where reclassification into entries is involved; C = entries with modified file scope where reclassification of documents from the entries is involved; Q = new entries which are firstly populated with documents via administrative transfers from deleted (D) entries. Afterwards, the transferred documents into the Q entry will either stay or be moved to more appropriate entries, as determined by intellectual reclassification; E= existing entries with enlarged file scope, which receive documents from C or D entries, e.g. when a limiting reference is removed from the entry title; M = entries with no change to the file scope (no reclassification); D = deleted entries; F = frozen entries will be deleted once reclassification of documents from the entries is completed; U = entries that are unchanged.

NOTES:

- **No {curly brackets} are used for titles in CPC only subclasses, e.g. C12Y, A23Y; 2000 series symbol titles of groups found at the end of schemes (orthogonal codes); or the Y section titles. The {curly brackets} are used for 2000 series symbol titles found interspersed throughout the main trunk schemes (breakdown codes).
- For U groups, the minimum requirement is to include the U group located immediately prior to the N group or N group array, in order to show the N group hierarchy and improve the readability and understanding of the scheme. Always include the symbol, indent level and title of the U group in the table above.
- All entry types should be included in the scheme changes table above for better understanding of the overall scheme change picture. Symbol, indent level, and title are required for all types except "D" which requires only a symbol.
- #“Transferred to” column must be completed for all C, D, F, and Q type entries. F groups will be deleted once reclassification is completed.
- When multiple symbols are included in the “Transferred to” column, avoid using ranges of symbols in order to be as precise as possible.
- For administrative transfer of documents, the following text should be used: “< administrative transfer to XX>” or “<administrative transfer to XX and YY simultaneously>” when administrative transfer of the same documents is to more than one place.

CPC NOTICE OF CHANGES 310

DATE: NOVEMBER 1, 2016

PROJECT RP0028

- Administrative transfer to main trunk groups is assumed to be “invention information”, unless otherwise indicated, and to 2000 series groups is assumed to be “additional information”.

2. A. DEFINITIONS (i.e. new)

B62K11/007

{Automatic balancing machines with single main group engaging wheel or coaxial wheels supporting a rider}

Definition statement

- Vehicles which use electrically driven wheel or wheels to remain upright while also propelling the rider in a desired direction.
- Control of the electric drive for balancing

Example figures:

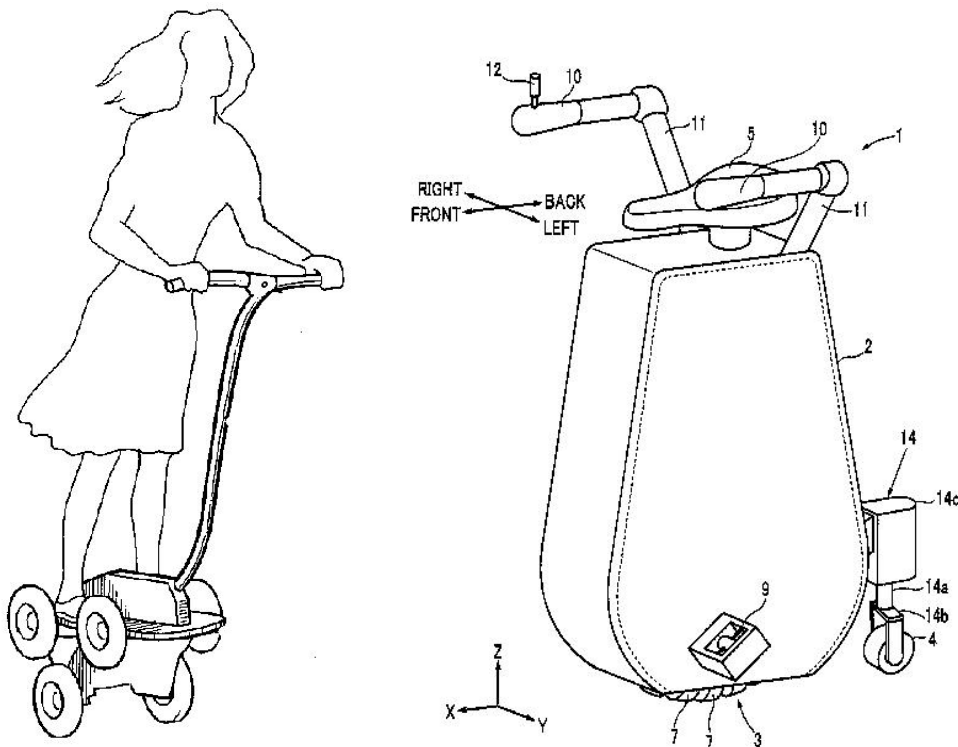

DATE: NOVEMBER 1, 2016

PROJECT RP0028

Special rules of classification

Balancing machines having a single main ground engaging wheel should be further classified in B62K1/00 for unicycles.

If there is an additional support wheel (see ref. 4 in the second figure) the device will still be considered a unicycle.

CPC NOTICE OF CHANGES 310

DATE: NOVEMBER 1, 2016

PROJECT RP0028

2. B. DEFINITIONS QUICK FIX

<u>Symbol</u>	<u>Location of change</u> (e.g., section title)	<u>Existing reference symbol or text</u>	<u>Action; New symbol; New text</u>
B62K3/007	Entire definition		Delete Entire Definition

NOTES:

- The table above is used for corrections or modifications to existing definitions, e.g. delete an entire definition or part thereof; propose new wording or modify wording of a section, change the symbol the definition is associated with, change or delete a reference symbol, etc.

CPC NOTICE OF CHANGES 310

DATE: NOVEMBER 1, 2016

PROJECT RP0028

3. REVISION CONCORDANCE LIST (RCL)

<u>Type*</u>	<u>From CPC Symbol (existing)</u>	<u>To CPC Symbol(s)</u>
D	B62K3/007	<administrative transfer to B62K11/007>

* C = entries with modified file scope where reclassification of documents from the entries is involved; Q = new entries which are firstly populated with documents via administrative transfers from deleted (D) entries. Afterwards, the transferred documents into the Q entry will either stay or be moved to more appropriate entries, as determined by intellectual reclassification; D = deleted entries.

NOTES:

- Only C, D, and Q type entries are included in the table above.
- When multiple symbols are included in the “To” column, avoid using ranges of symbols in order to be as precise as possible.
- For administrative transfer of documents, the following text should be used: “< administrative transfer to XX>” or “<administrative transfer to XX and YY simultaneously>” when administrative transfer of the same documents is to more than one place.
- Administrative transfer to main trunk groups is assumed to be “invention information”, unless otherwise indicated, and to 2000 series groups is assumed to be “additional information”.

CPC NOTICE OF CHANGES 310

DATE: NOVEMBER 1, 2016

PROJECT RP0028

4. CHANGES TO THE CPC-TO-IPC CONCORDANCE LIST (CICL)

<u>CPC</u>	<u>IPC</u>	<u>Action*</u>
B62K3/007		Delete
B62K11/007	B62K11/00	New

*Action column:

- For an (N) or (Q) entry, provide an IPC symbol and complete the Action column with "NEW."
- For an existing CPC main trunk entry or indexing entry where the existing IPC symbol needs to be changed, provide an updated IPC symbol and complete the Action column with "UPDATED."
- For a (D) CPC entry or indexing entry complete the Action column with "DELETE." IPC symbol does not need to be included in the IPC column.
- For an (N) 2000 series CPC entry which is positioned within the main trunk scheme (breakdown code) provide an IPC symbol and complete the action column with "NEW".
- For an (N) 2000 series CPC entry positioned at the end of the CPC scheme (orthogonal code), with no IPC equivalent, complete the IPC column with "CPCONLY" and complete the action column with "NEW".

NOTES:

- F symbols are not included in the CICL table above.
- E and M symbols are not included in the CICL table above unless a change to the existing IPC is desired.

CPC NOTICE OF CHANGES 310

DATE: NOVEMBER 1, 2016

PROJECT RP0028

5. CROSS-REFERENCE LIST (CRL)

Definitions references impacted by this revision project

<u>Location of reference to be changed</u>	<u>Referenced subclass or group to be changed</u>	<u>Section of definition</u>	<u>Action; New reference symbol; New text</u>
B62H1/10	A63B69/16	References - Informative references	<u>Transfer Informative reference pointing to A63B69/16 to References - Limiting references:</u> Training appliances or apparatus for cycling sport A63B69/16
B62H1/10	B62K11/007	References - Informative references	<u>Insert:</u> Automatic balancing machines with single main ground engaging wheel or coaxial wheels supporting a rider B62K11/007

NOTES:

- The CRL tables above are used for changes to locations **outside** of the project scope. Changes to references in scheme titles or definitions **inside** the project scope will be reflected in the “scheme change” template or one of the “definition” templates.
- In addition to other changes proposed in the tables above, in the column titled “Referenced subclass or group to be changed,” **referenced** D symbols should indicate an action of “delete” or should indicate a replacement symbol and **referenced** F symbols should indicate a replacement symbol.
- When a reference is deleted, text related to that reference will also be deleted unless other references or a range of references associated with the same text remain.