

B27B

SAWS FOR WOOD OR SIMILAR MATERIAL; COMPONENTS OR ACCESSORIES THEREFOR (saws specially adapted for pruning or debranching [A01G 3/08](#); sawing apparatus specially adapted for felling trees [A01G 23/091](#); features not restricted to a particular type of wood saw [B23D](#), e.g. attaching saw blades [B23D 51/00](#); machine tool frames, beds, pillars or like members, in general [B23Q 1/01](#))

Definition statement

This place covers:

Saws for sawing wood:

- Wood saws characterised by the active element:
 - reciprocating: [B27B 3/00](#), [B27B 11/00](#), [B27B 19/00](#)
 - circular: [B27B 5/00](#), [B27B 7/00](#), [B27B 9/00](#)
 - band or strap: [B27B 13/00](#), [B27B 15/00](#)
 - chain: [B27B 17/00](#)
 - other kinds: [B27B 23/00](#)
- Portable or hand saws for wood: [B27B 9/00](#), [B27B 21/00](#)
- Active elements of wood saws: [B27B 23/00](#), [B27B 33/00](#)
- Accessories for wood saws: [B27B 25/00](#), [B27B 31/00](#)
- Sawing trunks or logs, saws specially adapted therefor: [B27B 1/00](#), [B27B 3/00](#), [B27B 7/00](#), [B27B 15/00](#)

Relationships with other classification places

Other large areas covering sawing are [B23D 45/00-B23D 65/00](#) (sawing in general, sawing metal) and [B28D 1/02](#) (sawing stone). [B23D](#) is the main entry for sawing. Precedence is given to [B23D](#). Features not restricted to a particular type of saw are classified in [B23D](#). However, such features are classified in [B27B](#) if a more specific entry exists in [B27B](#), for example:

- [B27B 5/30](#): mounting/securing devices for circular saw blades or spindles
- [B27B 5/38](#): braking devices for the circular saw blade or the spindle
- [B27B 17/00](#): details of chain saws, equipment for chain saws
- [B27B 27/00](#): guide fences or stops
- [B27B 33/14](#): saw chains

References

Limiting references

This place does not cover:

Sawing in general (unless a more specific entry exists in B27B)	B23D 45/00 - B23D 65/04
Constructional features of particular parts per se of sawing machines or sawing devices	B23Q
Details or components, e.g. casings, bodies, of portable power-driven saws not particularly related to the operation performed	B25F 5/00
Safety guards or devices specially designed for wood saws	B27G 19/00

Sawing stone or stone-like materials	B28D 1/02
Accessories specially adapted for use with machines for sawing of gems, jewels, crystals	B28D 5/0058
Sawing gems, jewels, crystals with discs or wheels	B28D 5/022
Sawing gems, jewels, crystals with blades or wires	B28D 5/042 , B28D 5/045
Accessories specially adapted for use with machines or devices for sawing stone	B28D 7/00

Informative references

Attention is drawn to the following places, which may be of interest for search:

Saws specially adapted for pruning or debranching	A01G 3/08
Sawing apparatus specially adapted for felling trees	A01G 23/091
Meat or bone saws	A22B 5/20
Surgical saws	A61B 17/14
Saws for dentistry	A61C 3/12
Grinders for cutting-off	B24B 27/06
Auxiliary devices facilitating proper operation of wood saws	B27G 19/00

Glossary of terms

In this place, the following terms or expressions are used with the meaning indicated:

Feeding work	moving a workpiece into engagement with a saw blade while sawing
Conveying or transporting work	moving a workpiece before, after or between sawing operations
Discharging work	moving a workpiece away from a saw blade after sawing

B27B 1/00

Methods for subdividing trunks or logs essentially involving sawing

References

Informative references

Attention is drawn to the following places, which may be of interest for search:

Saw benches with non-feedable circular saw blades for cross-cutting laterally fed workpieces	B27B 5/228
Cross-cutting reciprocating saws with power drive	B27B 11/00

B27B 3/00

Gang saw mills; Other sawing machines with reciprocating saw blades, specially designed for length sawing of trunks

Definition statement

This place covers:

Gang saw mills; Other sawing machines with reciprocating saw blades, specially designed for length sawing of trunks

B27B 5/00

Sawing machines working with circular {or cylindrical} saw blades (for length sawing of trunks [B27B 7/00](#)); Components or equipment therefor

References**Limiting references**

This place does not cover:

Sawing machines working with circular saw blades for length sawing of trunks	B27B 7/00
Arrangements for adjusting the mutual distances of circular saw machines for lengthwise sawing of trunks	B27B 7/04
Circular saws combined with band or strap sawing machines specially designed for length cutting of trunks	B27B 15/06
Machines for cutting through a work-piece with a tool having a rotational vector which is parallel to the surfaces generated by cutting	B27C 1/007
Slotting or mortising machines	B27F 5/02

B27B 5/381

{with at least one brake member contacting saw blade portions}

Definition statement

This place covers:

Circular saws including one or more brake members that touch the saw blade, such as touching at the teeth of the saw blade as in the image below, or touching at one or more sides of the saw blade.

Illustrative example of subject matter classified in this place:

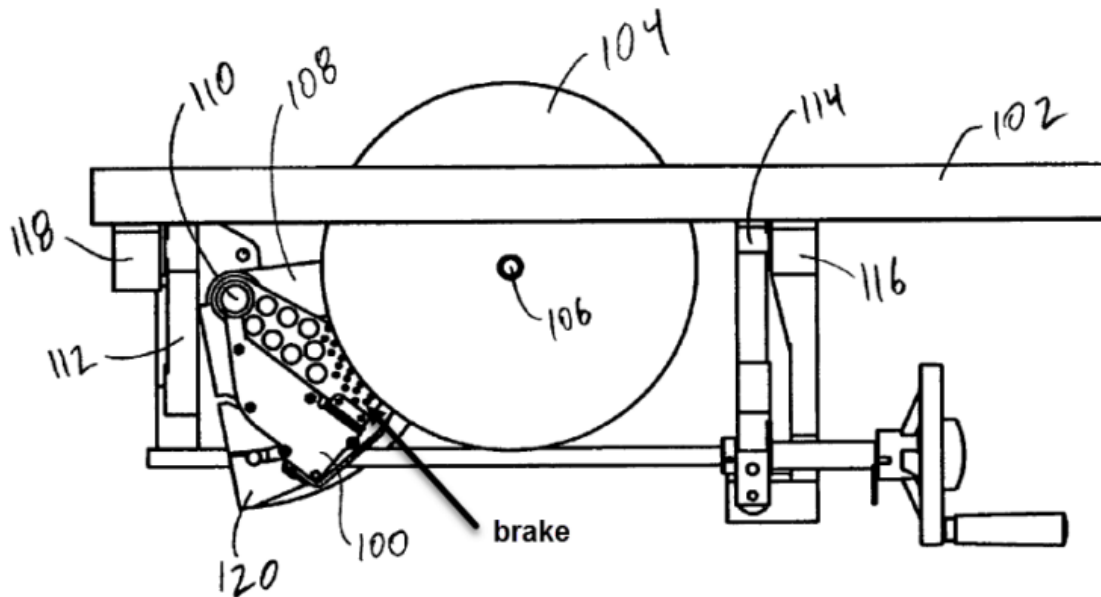

B27B 7/00

Sawing machines working with circular saw blades, specially designed for length sawing of trunks

References

Limiting references

This place does not cover:

Equipment for adjusting the mutual distance of circular wood saws in general	B27B 5/34
--	---------------------------

B27B 9/00

Portable power-driven circular saws for manual operation (details or components, e.g. handles, casings, of portable power-driven tools not particularly related to the operation performed [B25F 5/00](#))

References

Limiting references

This place does not cover:

Circular sawing machines for dividing plates in parts of determined size, e.g. panels	B27B 5/06
Details or components, e.g. casings, bodies, of portable power-driven saws not particularly related to the operation performed	B25F 5/00

B27B 11/00**Cross-cut reciprocating saws with power drive; Appurtenances therefor****Definition statement***This place covers:*

Saws with straight reciprocating saw blades.

B27B 13/00**Band or strap sawing machines (for length cutting of trunks [B27B 15/00](#));
Components or equipment therefor****References****Limiting references***This place does not cover:*

Band or strap sawing machines specially designed for length cutting of trunks	B27B 15/00
Devices for guiding strap saw blades in general	B23D 55/08
Devices for tensioning strap saw blades in general	B23D 55/10

B27B 13/141**{with at least one brake member contacting saw blade portions}****Definition statement***This place covers:*

Band saws including one or more brake members that touch the band saw blade, such as touching at the teeth of the band saw blade, or touching at one or more sides of the band saw blade.

Illustrative example of subject matter classified in this place:

Note, in the figure below, a brake member 16 contacts the side of the sawing band 4.

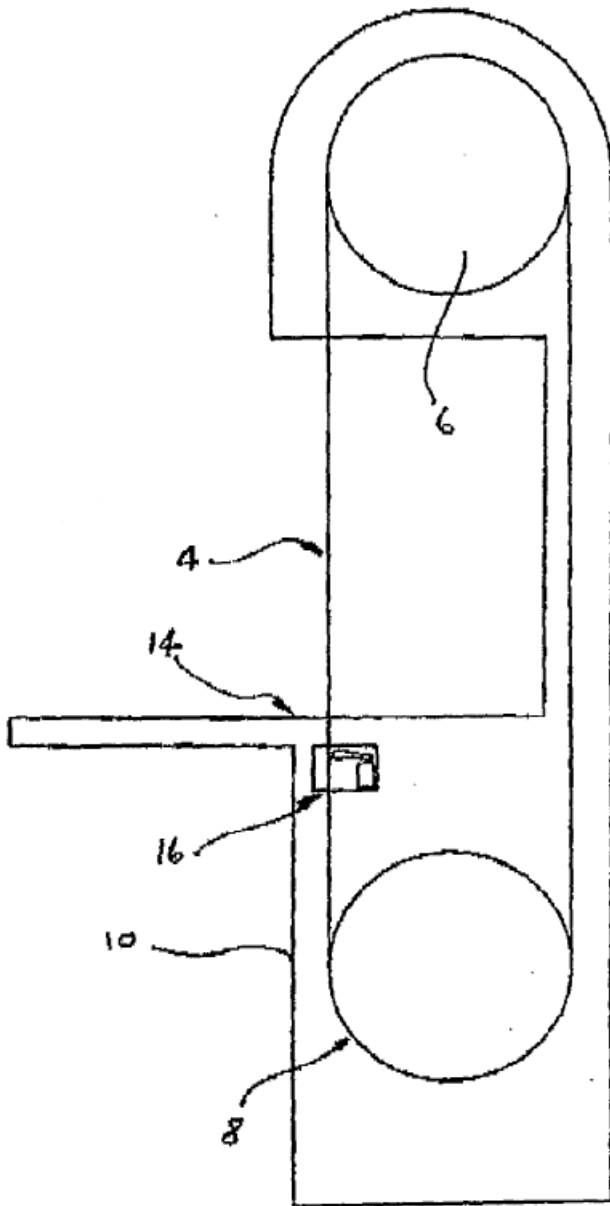

B27B 15/00

Band or strap sawing machines specially designed for length cutting of trunks

Definition statement

This place covers:

Band or strap sawing machines specially designed for length cutting of trunks

B27B 17/00

Chain saws; Equipment therefor {(slotting or mortising machines equipped with chain cutters [B27F 5/06](#))}

References**Limiting references**

This place does not cover:

Slotting or mortising machines equipped with chain cutters	B27F 5/06
--	---------------------------

B27B 17/142

{with adjustment by at least one cam}

Definition statement

This place covers:

Arrangements for stretching a chain saw including at least one cam, where the cam can be a rotational or linear cam, and where the cam can include an internal or external camming surface.

Illustrative example of subject matter classified in this place:

Note, in the figure below, a rotational cam (30) with an external camming surface.

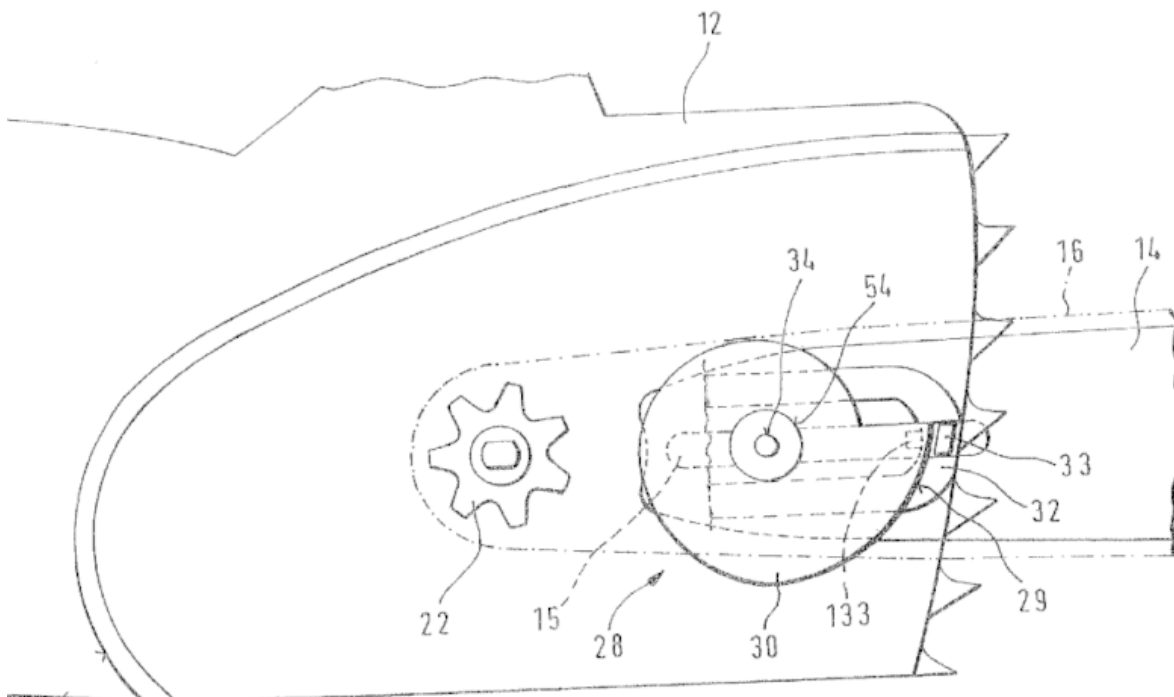

B27B 17/144**{with adjustment by at least one threaded screw}****Definition statement***This place covers:*

Illustrative example of subject matter classified in this place:

Note, in the figure below, threaded screw 382 is driven to rotate via rotation of knob 400, and rotation of the threaded screw 382 moves elements 310 and 370 in the direction of arrow 3105 to move guide bar 200 to adjust chain tension.

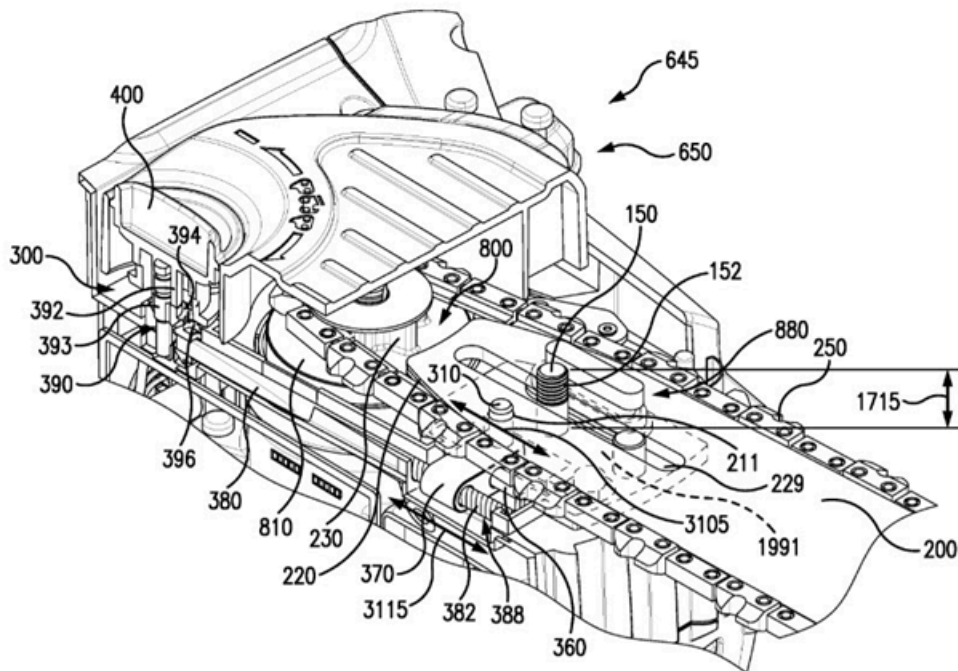
**B27B 17/146****{with adjustment of a non-driven sprocket or pulley relative to the guide bar}****Definition statement***This place covers:*

Illustrative example of subject matter classified in this place:

Note, in the figure below, where sprocket 16 is positionally adjusted relative to the guide bar 18, in order to tension the chain.

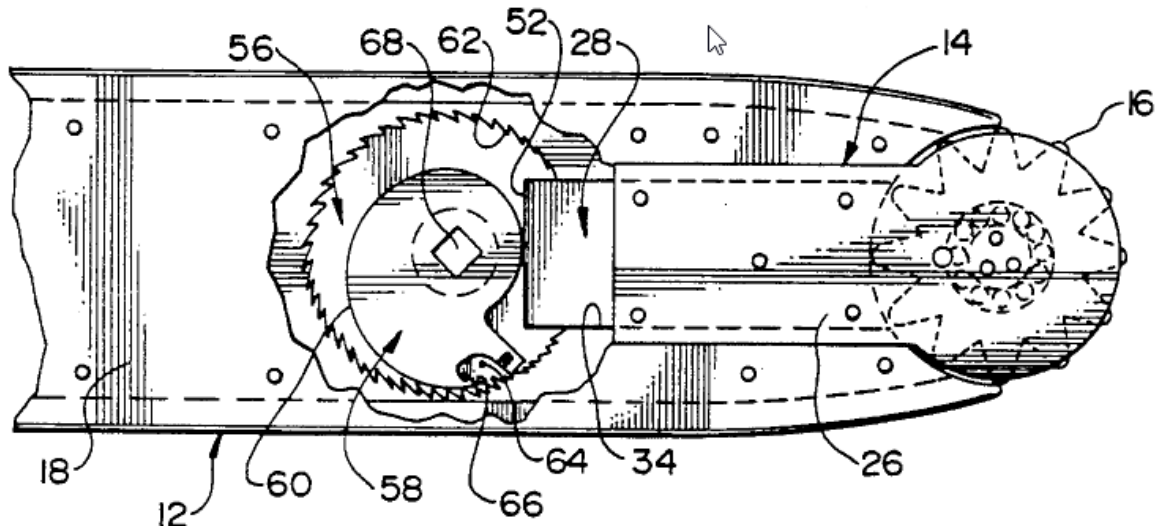

B27B 19/00

Other reciprocating saws with power drive; Fret-saws

Definition statement

This place covers:

Saws with oscillating saw blades	B27B 19/006
----------------------------------	-----------------------------

B27B 21/00

Hand saws without power drive (hand saws with oscillating saw blades, [B27B 19/14](#) takes precedence); Equipment for hand sawing, e.g. saw horses {(work benches [B25H 1/00](#); saw guides [B27B 11/02](#)}

References

Limiting references

This place does not cover:

Saw guides	B27B 11/02
Saws benches or saw bucks for chain saws	B27B 17/0041
Fret saws with hand drive	B27B 19/14
Work benches, horses in general	B25H 1/00

B27B 23/00

Other cutting of wood by non-rotary toothed tools; Tools therefor (cutting with hot wire [B27M 1/06](#))

References**Limiting references**

This place does not cover:

Cutting with hot wire	B27M 1/06
-----------------------	---------------------------

B27B 25/00

Feeding devices for timber in saw mills or sawing machines; Feeding devices for trees ({[B27B 29/00](#)}, [B27B 31/00](#) take precedence)

References**Limiting references**

This place does not cover:

Gripping, clamping, or holding devices for the trunk or log in saw mills or sawing machines; travelling trunk or log carriages	B27B 29/00
Arrangements for conveying, loading, turning, adjusting, or discharging the log or timber, specially designed for saw mills or sawing machines	B27B 31/00

B27B 27/00

Guide fences or stops for timber in saw mills or sawing machines; Measuring equipment thereon (safety guards or devices specially designed for wood saws [B27G 19/00](#); constructional features of measuring devices [G01B](#))

References**Limiting references**

This place does not cover:

Devices for mitring wood	B27G 5/00
Safety guards or devices specially designed for wood saws	B27G 19/00
Constructional features of measuring devices	G01B

B27B 29/00

Gripping, clamping or holding devices for the trunk or log in saw mills or sawing machines (safety guards or devices specially designed for wood saws [B27G 19/00](#)); Travelling trunk or log carriages {(for logs being held in a cantilever manner [B27B 17/0075](#))}

References**Limiting references**

This place does not cover:

Travelling trunk or log carriages for logs being held in a cantilever manner	B27B 17/0075
Safety guards or devices specially designed for wood saws	B27G 19/00

Informative references

Attention is drawn to the following places, which may be of interest for search:

Sawing machines or sawing devices working with circular saw blades, characterised only by constructional features of particular parts	B23D 47/00
Sawing machines or sawing devices working with straight blades, characterised only by constructional features of particular parts; Carrying or attaching means for tools, covered by this subclass, which are connected to a carrier at both ends	B23D 51/00
Sawing machines or sawing devices working with strap saw blades, characterised only by constructional features of particular parts	B23D 55/00
Sawing machines or sawing devices not covered by one of groups B23D 45/00 - B23D 55/00	B23D 57/00

B27B 31/00

Arrangements for conveying, loading, turning, adjusting, or discharging the log or timber, specially designed for saw mills or sawing machines ([B27B 29/00](#) takes precedence {; arrangements for raising or lowering the feed rollers of gang saw mills [B27B 3/14](#); driving mechanisms for the feed rollers of gang saw mills [B27B 3/16](#)})

References**Limiting references**

This place does not cover:

Arrangements for raising or lowering the feed rollers of gang saw mills	B27B 3/14
Driving mechanisms for the feed rollers of gang saw mills	B27B 3/16
Gripping, clamping, or holding devices for the trunk or log in saw mills or sawing machines; travelling trunk or log carriages	B27B 29/00
Article or material handling devices associated with conveyors	B65G 47/00

Informative references

Attention is drawn to the following places, which may be of interest for search:

Devices for determining the axis of a trunk	B27L 5/022
---	----------------------------

B27B 33/00

Sawing tools for saw mills, sawing machines, or sawing devices

References**Limiting references**

This place does not cover:

Saw chains for slotting or mortising devices	B27F 5/08
--	---------------------------