

## B27B

**SAWS FOR WOOD OR SIMILAR MATERIAL; COMPONENTS OR ACCESSORIES THEREFOR (saws specially adapted for pruning or debranching [A01G 3/08](#); sawing apparatus specially adapted for felling trees [A01G 23/091](#); features not restricted to a particular type of wood saw [B23D](#), e.g. attaching saw blades [B23D 51/00](#); machine tool frames, beds, pillars or like members, in general [B23Q 1/01](#))**

### Definition statement

*This place covers:*

Saws for sawing wood:

- Wood saws characterised by the active element:
  - reciprocating: [B27B 3/00](#), [B27B 11/00](#), [B27B 19/00](#)
  - circular: [B27B 5/00](#), [B27B 7/00](#), [B27B 9/00](#)
  - band or strap: [B27B 13/00](#), [B27B 15/00](#)
  - chain: [B27B 17/00](#)
  - other kinds: [B27B 23/00](#)
- Portable or hand saws for wood: [B27B 9/00](#), [B27B 21/00](#)
- Active elements of wood saws: [B27B 23/00](#), [B27B 33/00](#)
- Accessories for wood saws: [B27B 25/00](#), [B27B 31/00](#)
- Sawing trunks or logs, saws specially adapted therefor: [B27B 1/00](#), [B27B 3/00](#), [B27B 7/00](#), [B27B 15/00](#)

### Relationships with other classification places

Other large areas covering sawing are [B23D 45/00-B23D 65/00](#) (sawing in general, sawing metal) and [B28D 1/02](#) (sawing stone). [B23D](#) is the main entry for sawing. Precedence is given to [B23D](#). Features not restricted to a particular type of saw are classified in [B23D](#). However, such features are classified in [B27B](#) if a more specific entry exists in [B27B](#), for example:

- [B27B 5/30](#): mounting/securing devices for circular saw blades or spindles
- [B27B 5/38](#): braking devices for the circular saw blade or the spindle
- [B27B 17/00](#): details of chain saws, equipment for chain saws
- [B27B 27/00](#): guide fences or stops
- [B27B 33/14](#): saw chains

### References

#### Limiting references

*This place does not cover:*

Sawing in general (unless a more specific entry exists in <a href="#">B27B</a> )	<a href="#">B23D 45/00</a> - <a href="#">B23D 65/04</a>
Constructional features of particular parts per se of sawing machines or sawing devices	<a href="#">B23Q</a>
Details or components, e.g. casings, bodies, of portable power-driven saws not particularly related to the operation performed	<a href="#">B25F 5/00</a>
Safety guards or devices specially designed for wood saws	<a href="#">B27G 19/00</a>

Sawing stone or stone-like materials	<a href="#">B28D 1/02</a>
Accessories specially adapted for use with machines for sawing of gems, jewels, crystals	<a href="#">B28D 5/0058</a>
Sawing gems, jewels, crystals with discs or wheels	<a href="#">B28D 5/022</a>
Sawing gems, jewels, crystals with blades or wires	<a href="#">B28D 5/042</a> , <a href="#">B28D 5/045</a>
Accessories specially adapted for use with machines or devices for sawing stone	<a href="#">B28D 7/00</a>

### **Informative references**

*Attention is drawn to the following places, which may be of interest for search:*

Saws specially adapted for pruning or debranching	<a href="#">A01G 3/08</a>
Sawing apparatus specially adapted for felling trees	<a href="#">A01G 23/091</a>
Meat or bone saws	<a href="#">A22B 5/20</a>
Surgical saws	<a href="#">A61B 17/14</a>
Saws for dentistry	<a href="#">A61C 3/12</a>
Grinders for cutting-off	<a href="#">B24B 27/06</a>
Auxiliary devices facilitating proper operation of wood saws	<a href="#">B27G 19/00</a>

### **Glossary of terms**

*In this place, the following terms or expressions are used with the meaning indicated:*

Feeding work	moving a workpiece into engagement with a saw blade while sawing
Conveying or transporting work	moving a workpiece before, after or between sawing operations
Discharging work	moving a workpiece away from a saw blade after sawing

## **B27B 1/00**

**Methods for subdividing trunks or logs essentially involving sawing (features of machines used, see the relevant groups for the machines)**

### **References**

#### **Limiting references**

*This place does not cover:*

Saw benches with non-feedable circular saw blades for cross-cutting laterally fed workpieces	<a href="#">B27B 5/228</a>
Cross-cutting reciprocating saws with power drive	<a href="#">B27B 11/00</a>

**B27B 3/00**

**Gang saw mills; Other sawing machines with reciprocating saw blades, specially designed for length sawing of trunks**

**Definition statement**

*This place covers:*

Gang saw mills; Other sawing machines with reciprocating saw blades, specially designed for length sawing of trunks

**B27B 5/00**

**Sawing machines working with circular {or cylindrical} saw blades (for length sawing of trunks [B27B 7/00](#)); Components or equipment therefor**

**References****Limiting references**

*This place does not cover:*

Sawing machines working with circular saw blades for length sawing of trunks	<a href="#">B27B 7/00</a>
Arrangements for adjusting the mutual distances of circular saw machines for lengthwise sawing of trunks	<a href="#">B27B 7/04</a>
Circular saws combined with band or strap sawing machines specially designed for length cutting of trunks	<a href="#">B27B 15/06</a>
Machines for cutting through a work-piece with a tool having a rotational vector which is parallel to the surfaces generated by cutting	<a href="#">B27C 1/007</a>
Slotting or mortising machines	<a href="#">B27F 5/02</a>

**B27B 5/381**

**{with at least one brake member contacting saw blade portions}**

**Definition statement**

*This place covers:*

Circular saws including one or more brake members that touch the saw blade, such as touching at the teeth of the saw blade as in the image below, or touching at one or more sides of the saw blade.

Illustrative example of subject matter classified in this place:

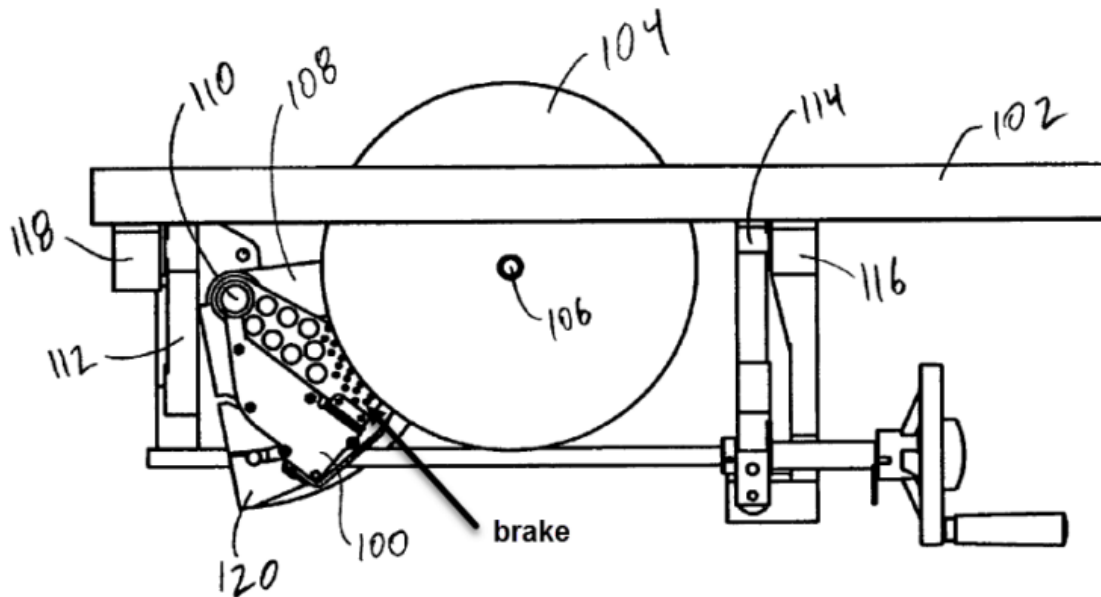

### B27B 7/00

Sawing machines working with circular saw blades, specially designed for length sawing of trunks

#### References

##### Limiting references

*This place does not cover:*

Equipment for adjusting the mutual distance of circular wood saws in general	<a href="#">B27B 5/34</a>
--	---------------------------

### B27B 9/00

Portable power-driven circular saws for manual operation (details or components, e.g. handles, casings, of portable power-driven tools not particularly related to the operation performed [B25F 5/00](#))

#### References

##### Limiting references

*This place does not cover:*

Circular sawing machines for dividing plates in parts of determined size, e.g. panels	<a href="#">B27B 5/06</a>
Details or components, e.g. casings, bodies, of portable power-driven saws not particularly related to the operation performed	<a href="#">B25F 5/00</a>

**B27B 11/00****Cross-cut reciprocating saws with power drive; Appurtenances therefor****Definition statement**

*This place covers:*

Saws with straight reciprocating saw blades.

**B27B 13/00****Band or strap sawing machines (for length cutting of trunks [B27B 15/00](#));  
Components or equipment therefor****References****Limiting references**

*This place does not cover:*

Band or strap sawing machines specially designed for length cutting of trunks	<a href="#">B27B 15/00</a>
Devices for guiding strap saw blades in general	<a href="#">B23D 55/08</a>
Devices for tensioning strap saw blades in general	<a href="#">B23D 55/10</a>

**B27B 13/141****{with at least one brake member contacting saw blade portions}****Definition statement**

*This place covers:*

Band saws including one or more brake members that touch the band saw blade, such as touching at the teeth of the band saw blade, or touching at one or more sides of the band saw blade.

Illustrative example of subject matter classified in this place:

Note, in the figure below, a brake member 16 contacts the side of the sawing band 4.

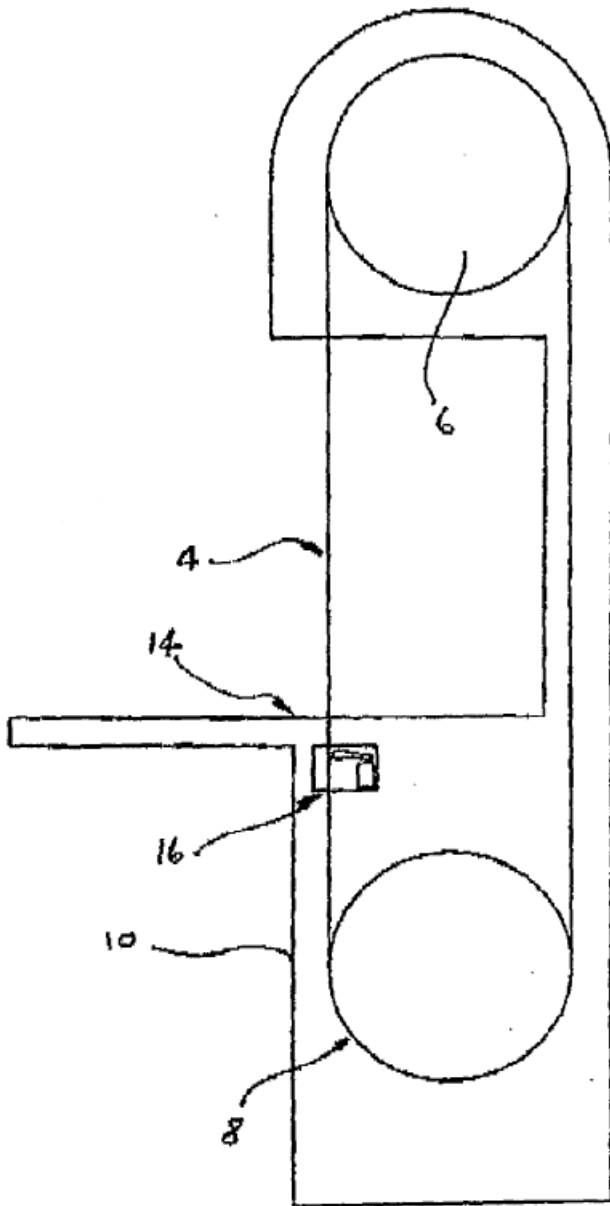

## B27B 15/00

**Band or strap sawing machines specially designed for length cutting of trunks**

### **Definition statement**

*This place covers:*

Band or strap sawing machines specially designed for length cutting of trunks

**B27B 17/00**

Chain saws; Equipment therefor {(slotting or mortising machines equipped with chain cutters [B27F 5/06](#))}

**References****Limiting references**

*This place does not cover:*

Slotting or mortising machines equipped with chain cutters	<a href="#">B27F 5/06</a>
--	---------------------------

**B27B 17/142**

{with adjustment by at least one cam}

**Definition statement**

*This place covers:*

Arrangements for stretching a chain saw including at least one cam, where the cam can be a rotational or linear cam, and where the cam can include an internal or external camming surface.

Illustrative example of subject matter classified in this place:

Note, in the figure below, a rotational cam (30) with an external camming surface.

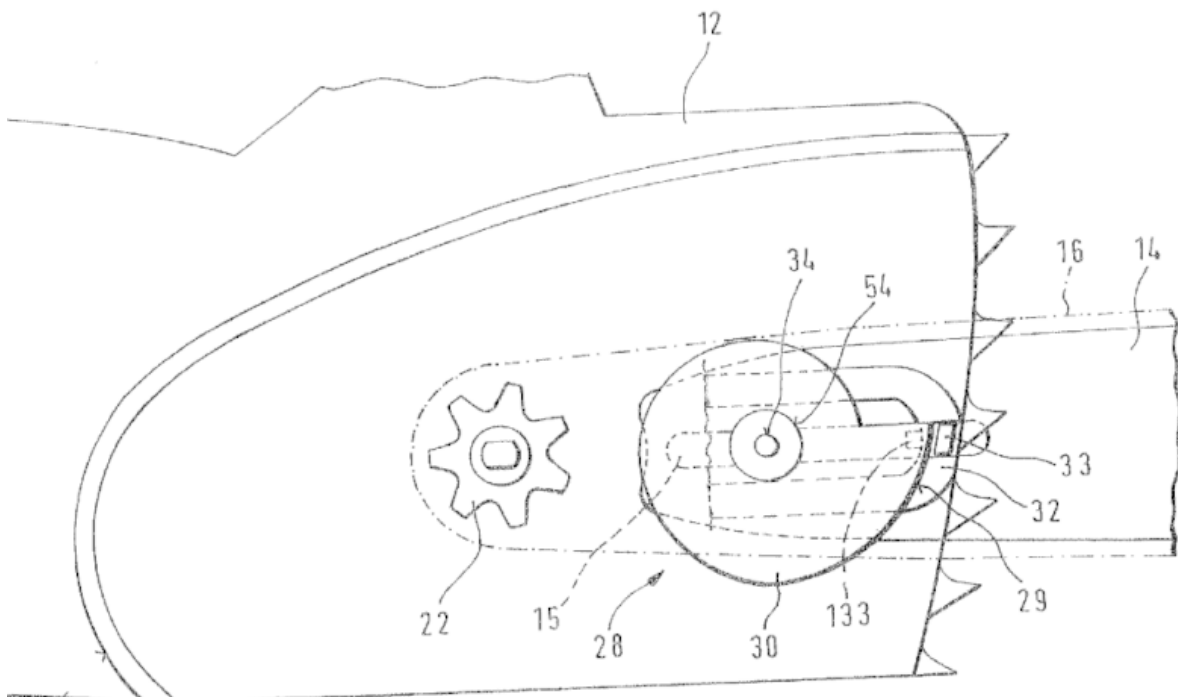

**B27B 17/144****{with adjustment by at least one threaded screw}****Definition statement***This place covers:*

Illustrative example of subject matter classified in this place:

Note, in the figure below, threaded screw 382 is driven to rotate via rotation of knob 400, and rotation of the threaded screw 382 moves elements 310 and 370 in the direction of arrow 3105 to move guide bar 200 to adjust chain tension.

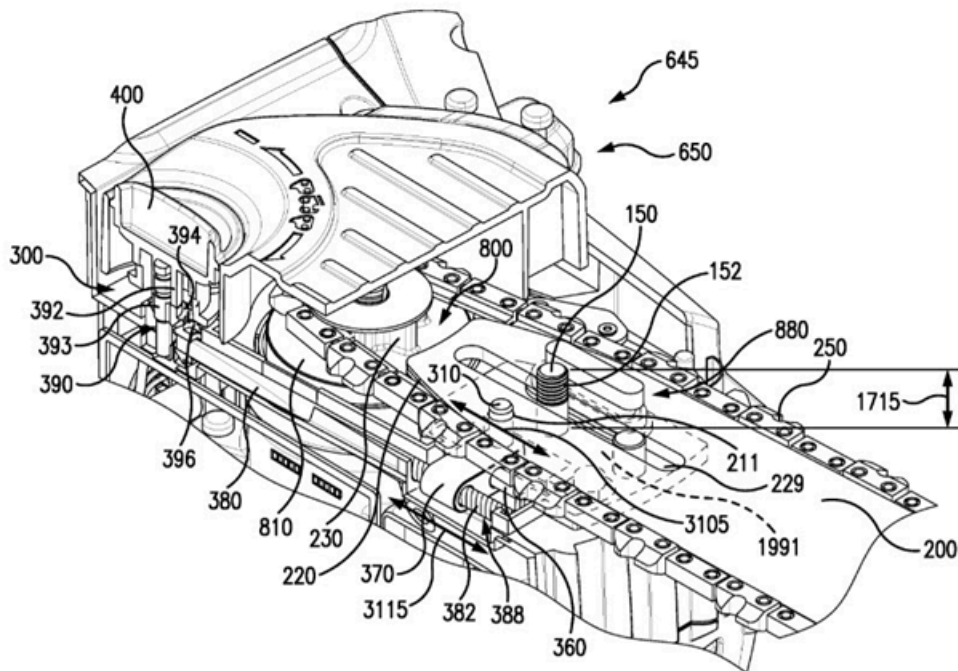
**B27B 17/146****{with adjustment of a non-driven sprocket or pulley relative to the guide bar}****Definition statement***This place covers:*

Illustrative example of subject matter classified in this place:



Note, in the figure below, where sprocket 16 is positionally adjusted relative to the guide bar 18, in order to tension the chain.

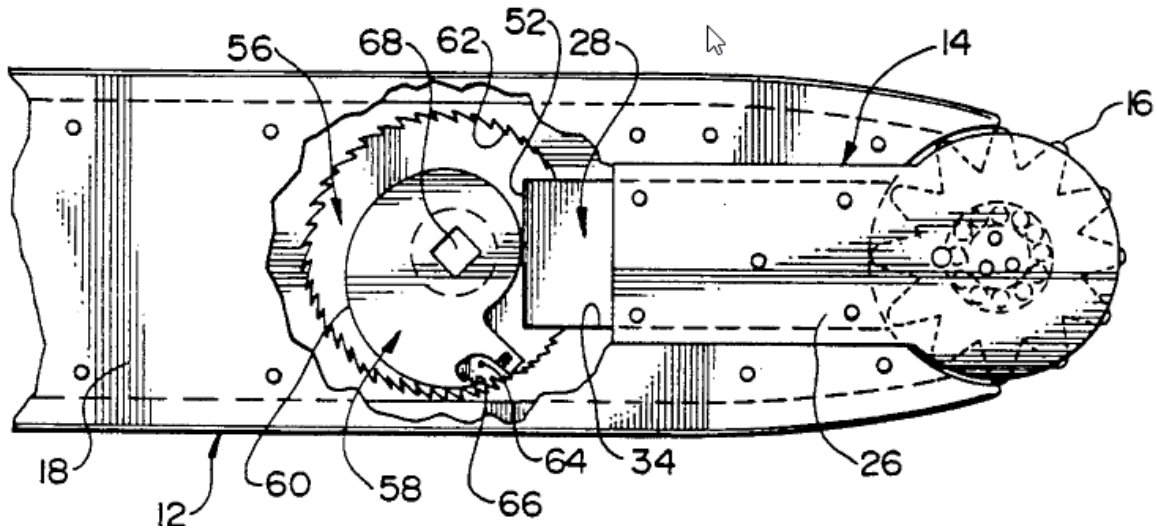

## B27B 19/00

Other reciprocating saws with power drive; Fret-saws

### Definition statement

*This place covers:*

Saws with oscillating saw blades	<a href="#">B27B 19/006</a>
----------------------------------	-----------------------------

## B27B 21/00

Hand saws without power drive ({{hand saws with oscillating saw blades,} [B27B 19/14](#) takes precedence); Equipment for hand sawing, e.g. saw horses {{(work benches [B25H 1/00](#); saw guides [B27B 11/02](#))}}

### References

#### Limiting references

*This place does not cover:*

Saw guides	<a href="#">B27B 11/02</a>
Saws benches or saw bucks for chain saws	<a href="#">B27B 17/0041</a>
Fret saws with hand drive	<a href="#">B27B 19/14</a>
Work benches, horses in general	<a href="#">B25H 1/00</a>

**B27B 23/00**

Other cutting of wood by non-rotary toothed tools; Tools therefor (cutting with hot wire [B27M 1/06](#))

**References****Limiting references**

*This place does not cover:*

Cutting with hot wire	<a href="#">B27M 1/06</a>
-----------------------	---------------------------

**B27B 25/00**

Feeding devices for timber in saw mills or sawing machines; Feeding devices for trees ({[B27B 29/00](#)}, [B27B 31/00](#) take precedence)

**References****Limiting references**

*This place does not cover:*

Gripping, clamping, or holding devices for the trunk or log in saw mills or sawing machines; travelling trunk or log carriages	<a href="#">B27B 29/00</a>
Arrangements for conveying, loading, turning, adjusting, or discharging the log or timber, specially designed for saw mills or sawing machines	<a href="#">B27B 31/00</a>

**B27B 27/00**

Guide fences or stops for timber in saw mills or sawing machines; Measuring equipment thereon (safety guards or devices specially designed for wood saws [B27G 19/00](#); constructional features of measuring devices [G01B](#))

**References****Limiting references**

*This place does not cover:*

Devices for mitring wood	<a href="#">B27G 5/00</a>
Safety guards or devices specially designed for wood saws	<a href="#">B27G 19/00</a>
Constructional features of measuring devices	<a href="#">G01B</a>

**B27B 29/00**

Gripping, clamping, or holding devices for the trunk or log in saw mills or sawing machines (for other timber, see the relevant groups for the machines; safety guards or devices specially designed for wood saws [B27G 19/00](#)); Travelling trunk or log carriages {(for logs being held in a cantilever manner [B27B 17/0075](#))}

**References****Limiting references**

*This place does not cover:*

Travelling trunk or log carriages for logs being held in a cantilever manner	<a href="#">B27B 17/0075</a>
Gripping, clamping, or holding devices, travelling carriages for other timber	<a href="#">B23D 47/00</a> , <a href="#">B23D 51/00</a> , <a href="#">B23D 55/00</a> , <a href="#">B23D 57/00</a>
Safety guards or devices specially designed for wood saws	<a href="#">B27G 19/00</a>

**B27B 31/00**

Arrangements for conveying, loading, turning, adjusting, or discharging the log or timber, specially designed for saw mills or sawing machines ([B27B 29/00](#) takes precedence {; arrangements for raising or lowering the feed rollers of gang saw mills [B27B 3/14](#); driving mechanisms for the feed rollers of gang saw mills [B27B 3/16](#)})

**References****Limiting references**

*This place does not cover:*

Arrangements for raising or lowering the feed rollers of gang saw mills	<a href="#">B27B 3/14</a>
Driving mechanisms for the feed rollers of gang saw mills	<a href="#">B27B 3/16</a>
Gripping, clamping, or holding devices for the trunk or log in saw mills or sawing machines; travelling trunk or log carriages	<a href="#">B27B 29/00</a>
Article or material handling devices associated with conveyors	<a href="#">B65G 47/00</a>

**Informative references**

*Attention is drawn to the following places, which may be of interest for search:*

Devices for determining the axis of a trunk	<a href="#">B27L 5/022</a>
---	----------------------------

## **B27B 33/00**

**Sawing tools for saw mills, sawing machines, or sawing devices**

### **References**

#### ***Limiting references***

*This place does not cover:*

Saw chains for slotting or mortising devices	<a href="#">B27F 5/08</a>
--	---------------------------